

CONSULTANTS

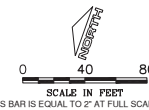

ISSUED FOR BID
TAXIWAY BRAVO WEST
RELOCATION

OWNER



RICHARD B. RUSSELL
REGIONAL AIRPORT
FLOYD COUNTY, GEORGIA

MARK DATE DESCRIPTION

CMT PROJECT NO: 22004559-00
CAD DWG FILE: 22004559-CP-2.DWG
DESIGNED BY: JBH/JMM
DRAWN BY: JBH
CHECKED BY: JMM
APPROVED BY: MJR
COPYRIGHT: CRAWFORD, MURPHY & TILLY, INC. 2026

SHEET TITLE

PLAN AND PROFILE -
TAXIWAY R2

SHEET 29 OF 81

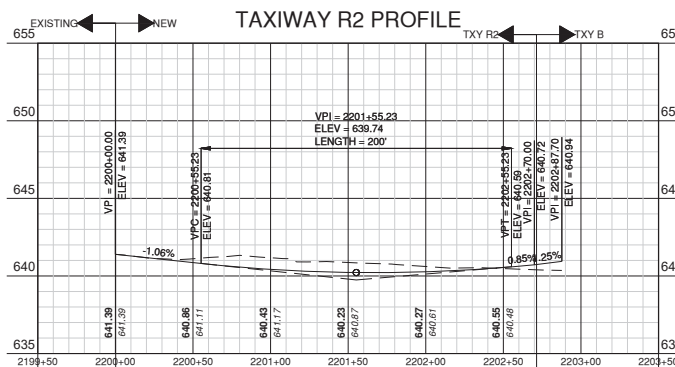
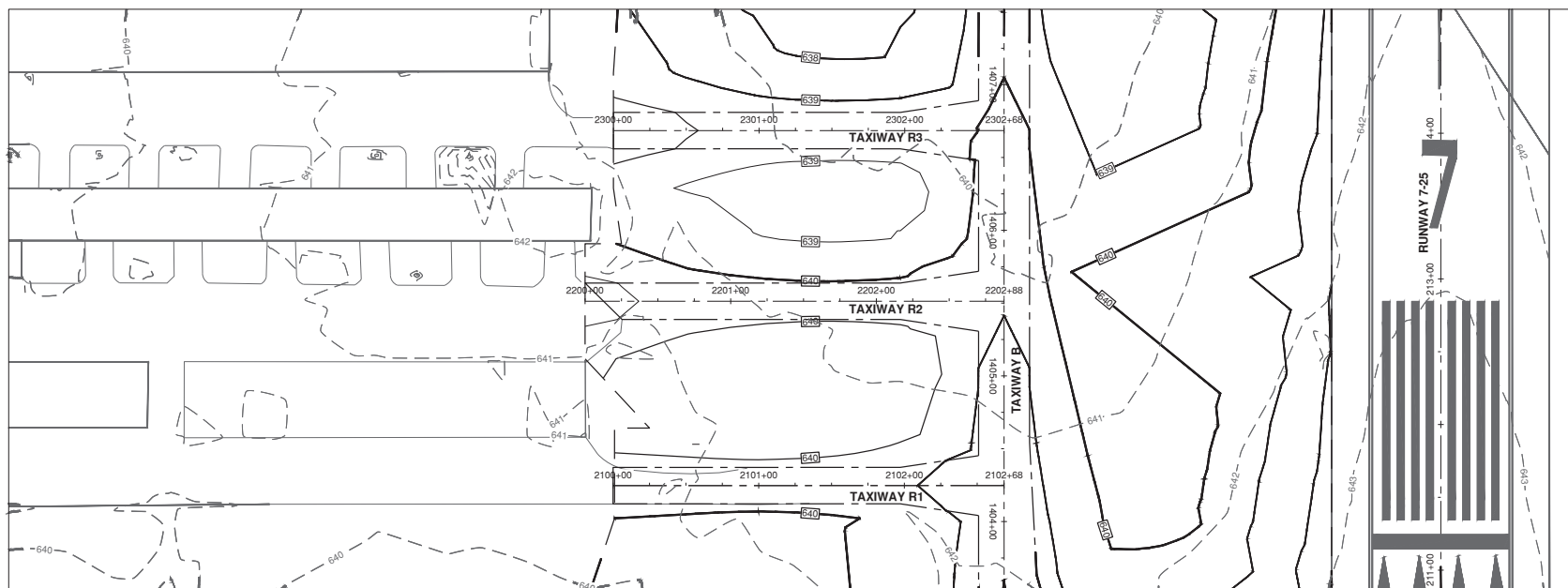

CONSULTANTS

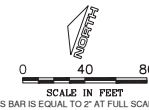

ISSUED FOR BID
TAXIWAY BRAVO WEST
RELOCATION

OWNER



RICHARD B. RUSSELL
REGIONAL AIRPORT
FLOYD COUNTY, GEORGIA

MARK	DATE	DESCRIPTION

CMT PROJECT NO: 22004559-00
CAD DWG FILE: 22004559-CP-2.DWG
DESIGNED BY: JBH/JMM
DRAWN BY: JBH
CHECKED BY: JMM
APPROVED BY: MJR
COPYRIGHT: CRAWFORD, MURPHY & TILLY, INC. 2026

SHEET TITLE
**PLAN AND PROFILE -
TAXIWAY R5**

SHEET **32** OF **81**

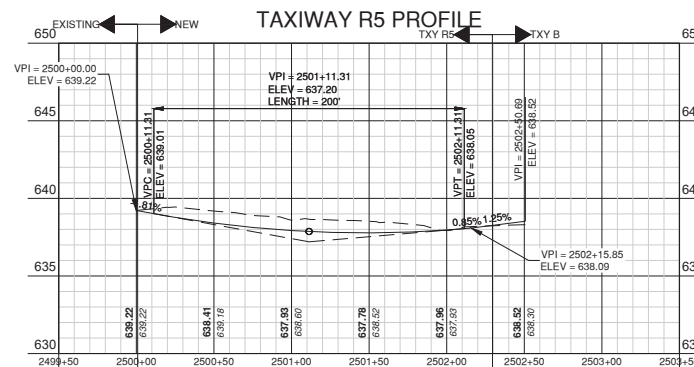
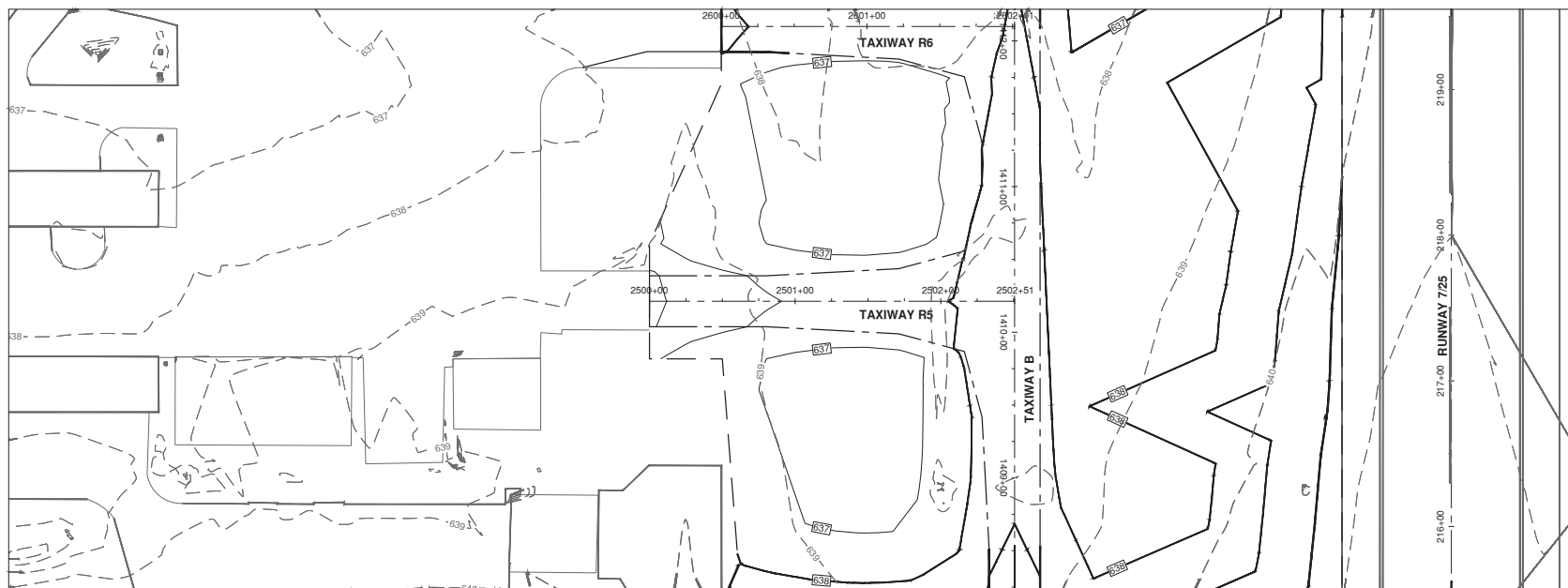

CONSULTANTS



0 40 80

SCALE: IN FEET

THIS BAR IS EQUAL TO 2" AT FULL SCALE (22X34)



ISSUED FOR BID

TAXIWAY BRAVO WEST
RELOCATION

OWNER



RICHARD B. RUSSELL
REGIONAL AIRPORT
FLOYD COUNTY, GEORGIA

MARK DATE DESCRIPTION

CMT PROJECT NO:	22004559-00
CAD DWG FILE:	22004559-CU-1.DWG
DESIGNED BY:	-
DRAWN BY:	-
CHECKED BY:	-
APPROVED BY:	-
COPYRIGHT:	CRAWFORD, MURPHY & TILLY, INC. 2026

SHEET TITLE
**GRADING AND
DRAINAGE - SHEET 1**

CU-101
SHEET 37 OF 81

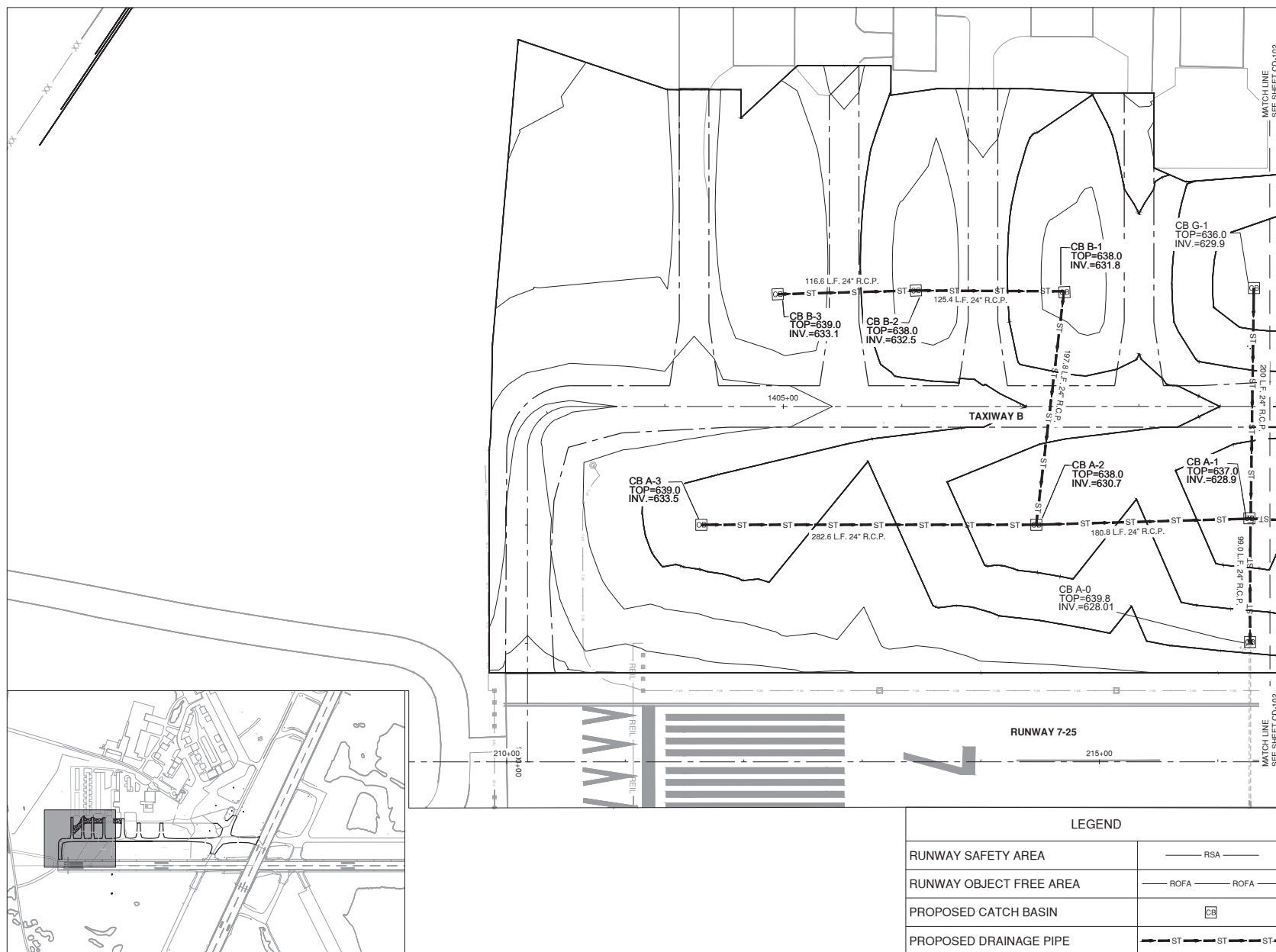

LEGEND	
RUNWAY SAFETY AREA	— RSA —
RUNWAY OBJECT FREE AREA	— ROFA — ROFA —
PROPOSED CATCH BASIN	CB
PROPOSED DRAINAGE PIPE	— ST — ST — ST —

Path: K:\RichardRussell\A\22004559\00_RMG_D_TaxiwayWest\Run\Draw\Sheet\22004559-CU-1.dwg
Date: Tuesday, June 2, 2026 11:22:34 AM

CONSULTANTS

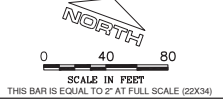

ISSUED FOR BID

TAXIWAY BRAVO WEST
RELOCATION

OWNER



RICHARD B. RUSSELL
REGIONAL AIRPORT
FLOYD COUNTY, GEORGIA

MARK DATE DESCRIPTION

CMT PROJECT NO: 22004559-00
CAD DWG FILE: 22004559-CU-1.DWG
DESIGNED BY: --
DRAWN BY: --
CHECKED BY: --
APPROVED BY: --
COPYRIGHT: CRAWFORD, MURPHY & TILLY, INC. 2026

SHEET TITLE
**GRADING AND
DRAINAGE - SHEET 2**

SHEET 38 OF 81

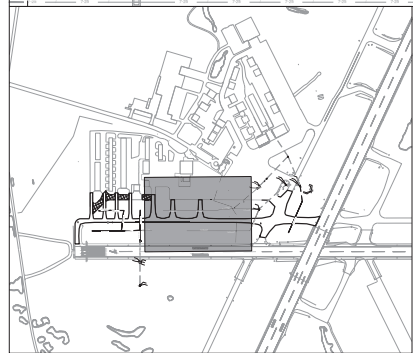
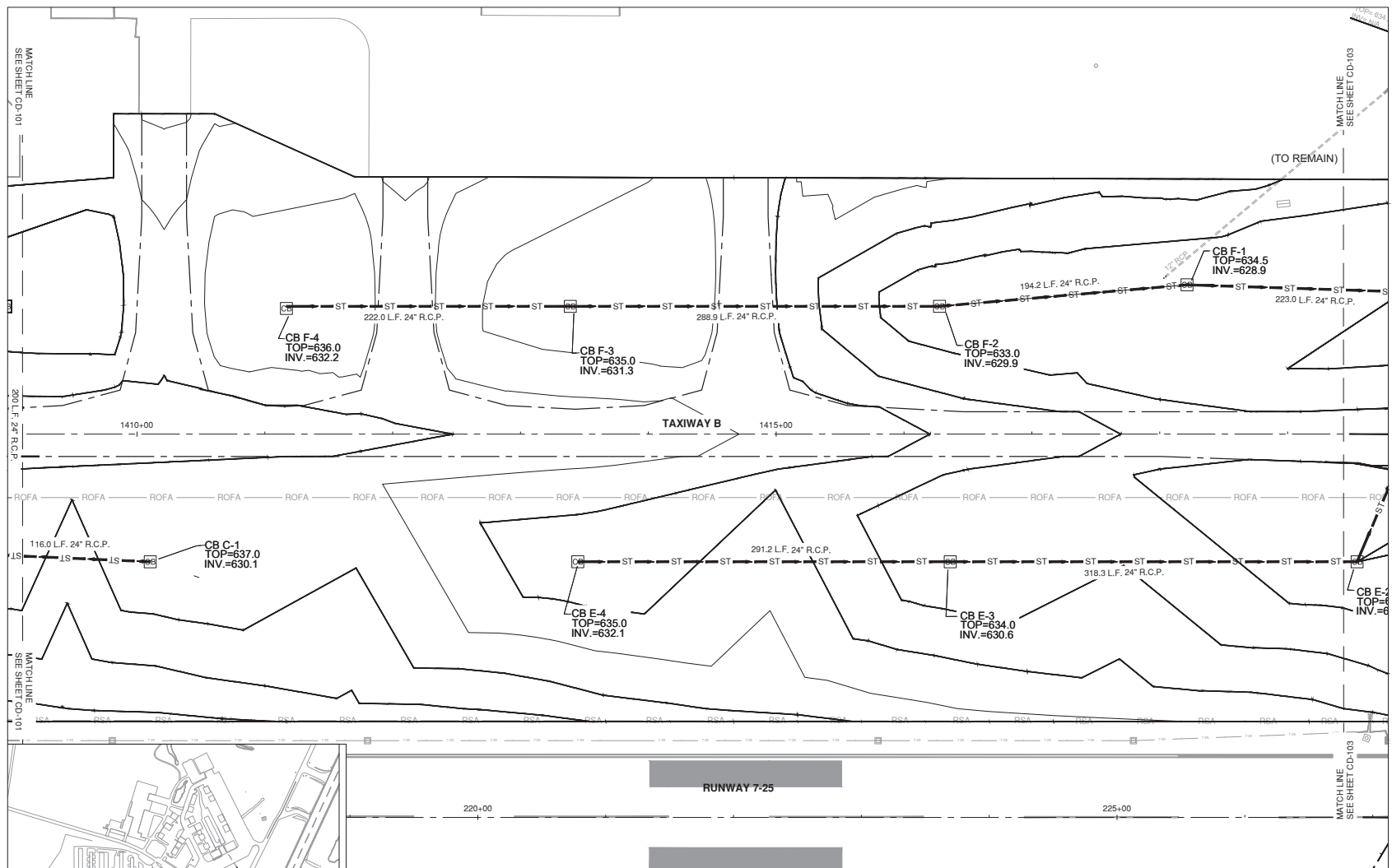

LEGEND	
RUNWAY SAFETY AREA	— RSA —
RUNWAY OBJECT FREE AREA	— ROFA — ROFA —
PROPOSED CATCH BASIN	CB
PROPOSED DRAINAGE PIPE	— ST — ST — ST —

Path: K:\RichardRussell\A\22004559-00_RMG_D_TaxiwayWest\Run\Draw\Sheet2\22004559-CU-1.dwg
 Date: Tuesday, June 2, 2026 11:20:40 AM

CONSULTANTS



0 40 80

SCALE: IN FEET

THIS BAR IS EQUAL TO 2" AT FULL SCALE (22X34)



ISSUED FOR BID

TAXIWAY BRAVO WEST
RELOCATION

OWNER



RICHARD B. RUSSELL
REGIONAL AIRPORT
FLOYD COUNTY, GEORGIA

MARK DATE DESCRIPTION

CMT PROJECT NO:	22004559-00
CAD DWG FILE:	22004559-CU-1.DWG
DESIGNED BY:	-
DRAWN BY:	-
CHECKED BY:	-
APPROVED BY:	-
COPYRIGHT:	CRAWFORD, MURPHY & TILLY, INC. 2026

SHEET TITLE
**GRADING AND
DRAINAGE - SHEET 3**

CU-103
SHEET 39 OF 81

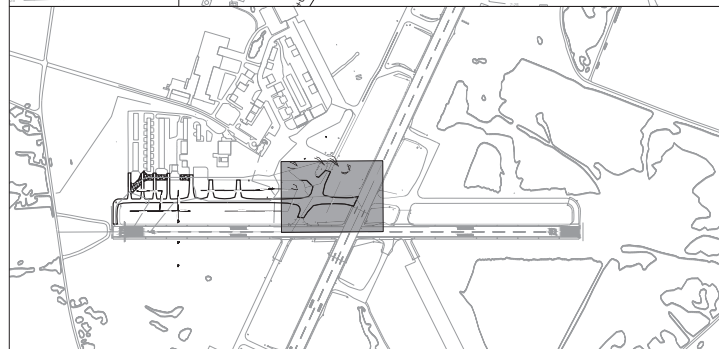
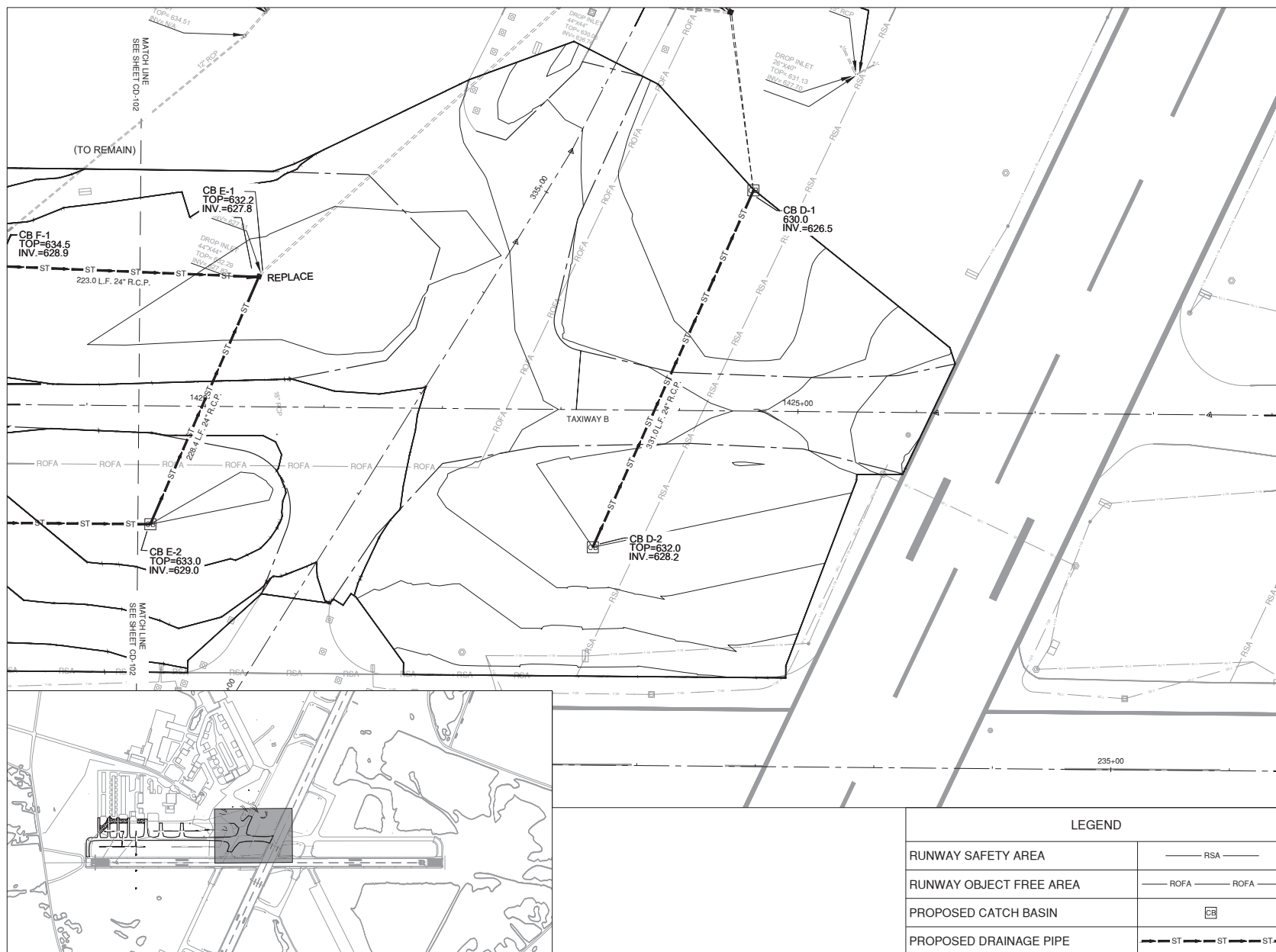

LEGEND	
RUNWAY SAFETY AREA	— RSA —
RUNWAY OBJECT FREE AREA	— ROFA — ROFA —
PROPOSED CATCH BASIN	CB
PROPOSED DRAINAGE PIPE	— ST — ST — ST —

Path: K:\RichardRussell\A\22004559\00_RMG_D_TaxiwayWest\Realign\Draw\Sheets\22004559-CU-1.dwg
Date: Tuesday, June 2, 2026 11:20:05 AM

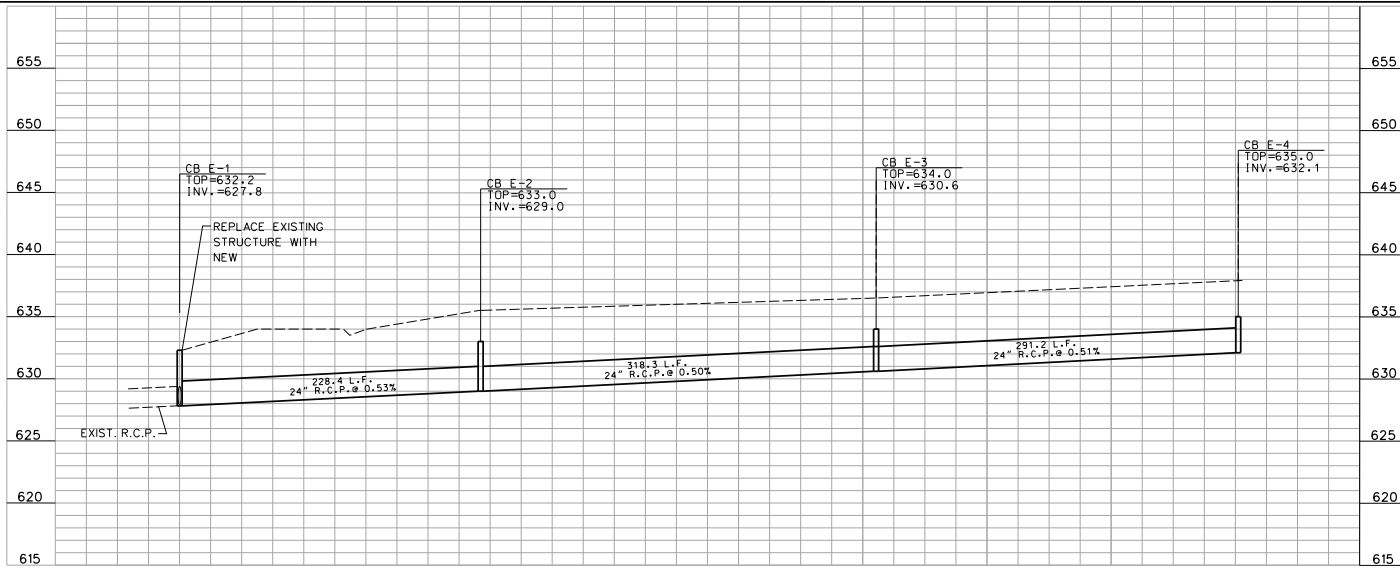

LINE "E" PROFILE
 SCALE: 1" = 50' HORIZ.
 1" = 5' VERT.

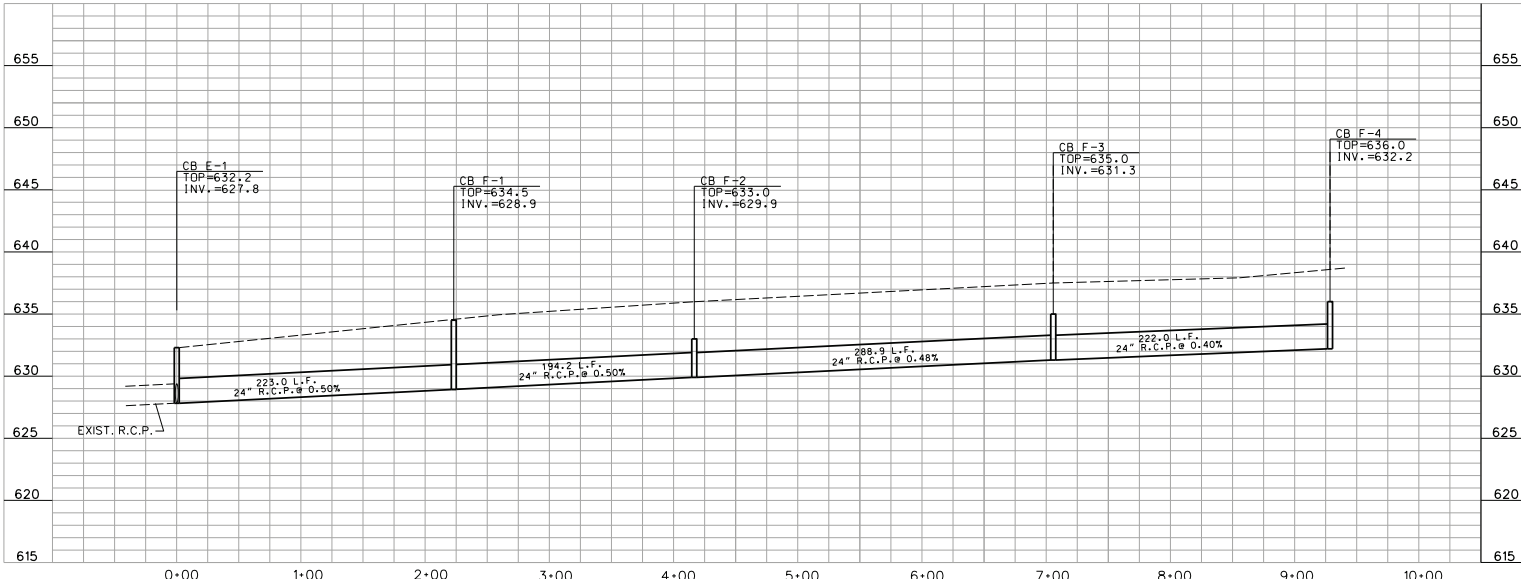

LINE "F" PROFILE
 SCALE: 1" = 50' HORIZ.
 1" = 5' VERT.



CONSULTANTS

THIS BAR IS EQUAL TO 2" AT FULL SCALE (22X34)

TAXIWAY BRAVO WEST
 RELOCATION

OWNER



RICHARD B. RUSSELL
 REGIONAL AIRPORT
 FLOYD COUNTY, GEORGIA

MARK	DATE	DESCRIPTION

CMT PROJECT NO:
 CAD DWG FILE:
 DESIGNED BY:
 DRAWN BY:
 CHECKED BY:
 APPROVED BY:
 COPYRIGHT: CRAWFORD, MURPHY & TILLY, INC. 2021

SHEET TITLE

STORM DRAIN
 PROFILES

CU-002
 SHEET OF 17

CONSULTANTS

THIS BAR IS EQUAL TO 2" AT FULL SCALE (22X34)

TAXIWAY BRAVO WEST
RELOCATION

OWNER



RICHARD B. RUSSELL
REGIONAL AIRPORT
FLOYD COUNTY, GEORGIA

MARK	DATE	DESCRIPTION

CMT PROJECT NO:
CAD DWG FILE:
DESIGNED BY:
DRAWN BY:
CHECKED BY:
APPROVED BY:
COPYRIGHT: CRAWFORD, MURPHY & TILLY, INC. 2021

SHEET TITLE

STORM DRAIN
PROFILES

CU-003

SHEET OF 17

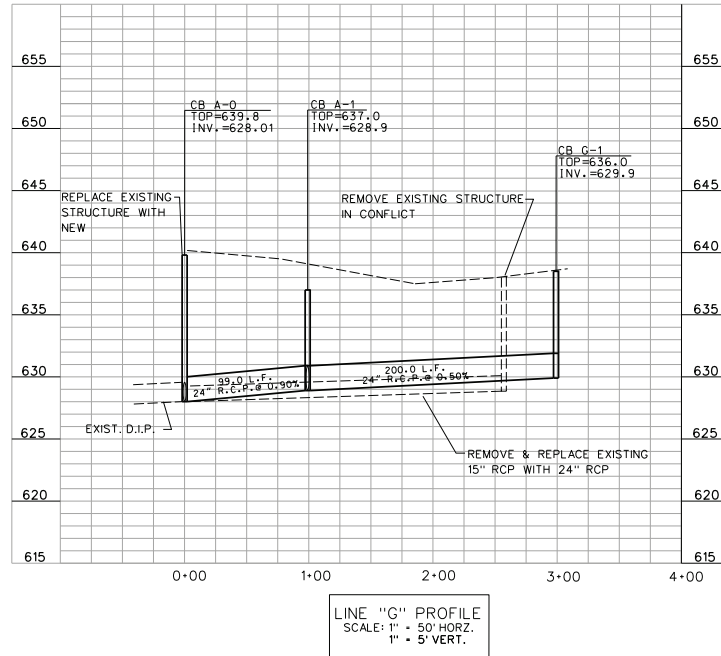

CONSULTANTS

THIS BAR IS EQUAL TO 2" AT FULL SCALE (22X34)



ISSUED FOR BID

TAXIWAY BRAVO WEST
RELOCATION

OWNER



RICHARD B. RUSSELL
REGIONAL AIRPORT
FLOYD COUNTY, GEORGIA

MARK	DATE	DESCRIPTION

CMT PROJECT NO: 22004559-00
CAD DWG FILE: 22004559-CU-5.DWG
DESIGNED BY: JBH/JMM
DRAWN BY: JBH
CHECKED BY: JMM
APPROVED BY: MJR
COPYRIGHT: CRAWFORD, MURPHY & TILLY, INC. 2026

SHEET TITLE
DRAINAGE DETAILS - SHEET 1

SHEET 43 OF 81
CU-501

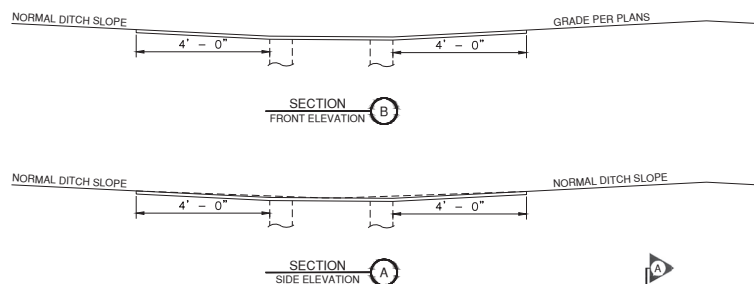

STORM DRAIN INLET GENERAL NOTES:

- THESE DIMENSIONS REPRESENT MINIMUM REQUIREMENTS. CONTRACTOR SHALL PROVIDE DETAILED SHOP DRAWINGS FOR APPROVAL PRIOR TO CONSTRUCTION.
- CATCH BASINS SHALL BE PRECAST. CONTRACTOR TO HAVE ENGINEER'S APPROVAL TO USE CAST IN PLACE ALTERNATIVE. IF CAST IN PLACE, P-610 CONCRETE SHALL BE USED. FOR PRECAST CONSTRUCTION, A MIN. OF CLASS 4000 PSI CONCRETE SHALL BE USED.
- CONCRETE WALLS SHALL HAVE A MIN. REINFORCING STEEL ASTM A184 AREA OF 0.20 SQ. IN. PER FT. UNLESS NOTED.
- REINFORCING STEEL SHALL BE ASTM A-706, LOW-ALLOY STEEL DEFORMED BARS FOR CONCRETE REINFORCEMENT, GRADE 80.
- LOCATION AND SIZE OF PIPES ARE SITE SPECIFIC, (SEE DRAINAGE PLANS), THE BOTTOM OF THE CATCH BASIN IS TO BE GROUTED TO THE LOWEST FLOW LINE ELEVATION OF ALL PIPES. IF BOTTOM SLAB IS CAST IN PLACE WITH PIPES INSTALLED, BOTTOM SLAB THICKNESS MUST BE ACHIEVED BEYOND PIPE OUTSIDE DIAMETER.
- IF BOX DEPTH EXCEEDS 4'-6" METAL STEPS ARE TO BE PLACED ON WALL - SEE STEP DETAIL.

FRAME AND GRATE NOTES:

- ALL JOINTS SHALL BE PREPARED BY SAWING OR FLAME CUTTING WITH DIMENSIONAL VARIATIONS OF 1/8" MAX.
- WELDING SHALL BE OF GOOD WORKMANSHIP AND IN ACCORDANCE WITH WELD SIZE REQUIREMENTS.
- JIGS SHALL BE USED DURING THE WELDING PROCESS TO ASSURE SQUARENESS AND FLATNESS OF THE UNITS.
- CORNERS MAY BE CUT AS SHOWN OR CUT AND BUTT WELDED. WELDS THAT ARE PART OF THE METAL BEARING SURFACES SHALL BE GROUND FLUSH.
- ENDS OF TUBES SHALL BE BEVELED IN ANGLE CORNER TO ASSURE CONTACT BETWEEN TUBE AND ANGLE LEG.
- FLAT BAR 4" X 1/2" PLATES SHALL BE SQUARE BUTTED AND WELDED BOTH SIDES AT END JOINTS. EDGE SHALL BE WELDED CONTINUOUSLY ON OUTSIDE OF FRAME WITH 1/4" FILLET WELD.
- BEFORE PAINTING ALL MILL SCALE, LOOSE RUST, AND OTHER CONTAMINATES SHALL BE REMOVED BY MEANS OF SANDBLASTING OR OTHER MEANS OF POWER CLEANING TO ESTABLISH A CLEAN SURFACE.
- EXTRA STRONG STEEL PIPE SHALL CONFORM TO ASTM A 53, NPS - 3, SCHEDULE 80. SCHEDULE 80 IS WALL THICKNESS = 0.300". A CERTIFICATION SHALL BE OBTAINED FOR EACH SHIPMENT AND THE PIPE SHALL BE DESIGNED FOR H-20 LOADING.
- STRUCTURAL STEEL FOR ANGLES AND BARS SHALL CONFORM TO ASTM A 36. A CERTIFICATION SHALL BE OBTAINED FOR EACH SHIPMENT.
- PAINT SHALL CONSIST OF TWO COATS OF PRIMER AND ONE COAT OF FINISH BLACK. THE PRIMER SHALL BE BASIC LEAD SILICA CHROMATE OR ZINC-IRON OXIDE BASE. THE FINISH COAT SHALL BE BLACK ALKYD GLOSS ENAMEL. ALL PRODUCTS SHALL BE HIGH QUALITY COMMERCIAL PAINTS.

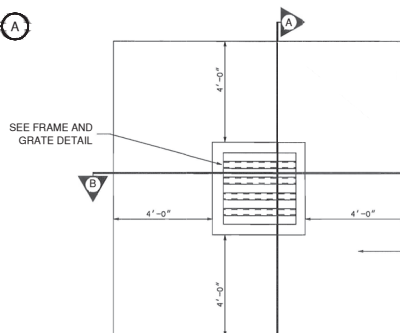

STORM DRAIN INLET MAINTENANCE PAD DETAIL

N.T.S.

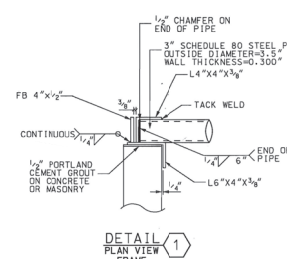

DETAIL 1
PLAN VIEW
FRAME

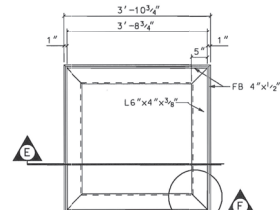

DETAIL 2
PLAN VIEW
FRAME

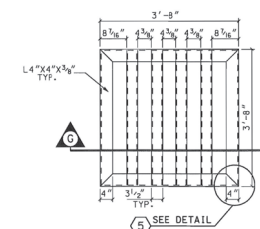

DETAIL 3
PLAN VIEW
GRATE

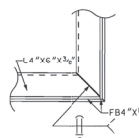

DETAIL 4
FRAME WELD



DETAIL 5
GRATE WELD

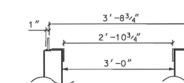

SECTION E
SIDE ELEVATION
OF FRAME

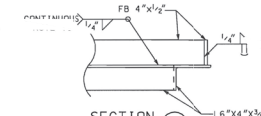

SECTION F
FLAT BAR
WELDS

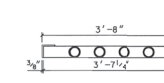

SECTION G
SIDE ELEVATION
OF GRATE

FRAME AND GRATE DETAIL

N.T.S.

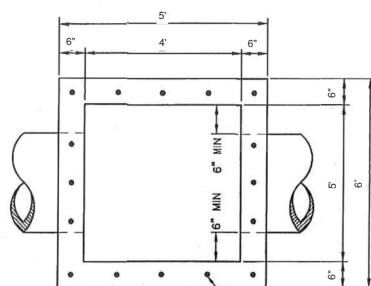

PLAN VIEW
N.T.S.

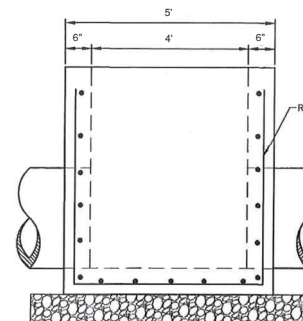

FRONT VIEW
N.T.S.

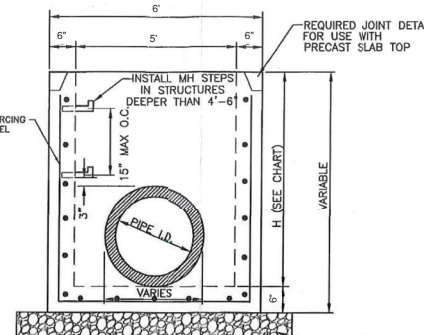

SIDE VIEW
N.T.S.

STORM DRAIN INLET DETAIL

N.T.S.

H	REINFORCEMENT SPACING
<10'	#4 @ 12" ON CENTER VERTICAL #4 @ 12" ON CENTER HORIZONTAL
10'-12'	#5 @ 12" ON CENTER VERTICAL #5 @ 12" ON CENTER HORIZONTAL
≥12'	#5 @ 12" ON CENTER VERTICAL #5 @ 8" ON CENTER HORIZONTAL

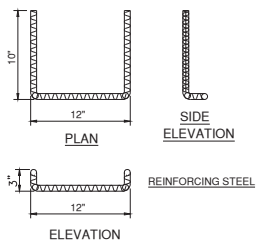

NOTE:
STEPS DIFFERING IN DIMENSIONS, CONFIGURATION, OR MATERIALS FROM THOSE SHOWN MAY ALSO BE USED PROVIDED THE CONTRACTOR HAS FURNISHED THE ENGINEER WITH DETAILS OF THE PROPOSED STEPS AND HAS RECEIVED WRITTEN APPROVAL FROM THE ENGINEER FOR THE USE OF SUCH STEPS. ALL STEPS SHALL PROTRUDE 4" FROM INSIDE FACE OF STRUCTURE WALL. STEPS SHALL BE PLACED 15" CENTER TO CENTER ON WALL.

STEP DETAIL

N.T.S.

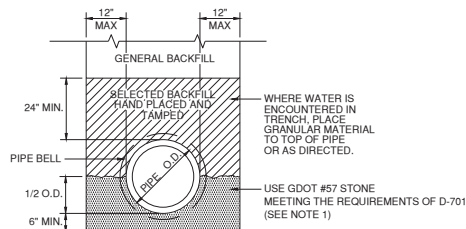

CLASS "B" PIPE BEDDING

N.T.S.

NOTE:

1. COST IS CONSIDERED INCIDENTAL TO THE COST OF THE PIPE.

STRUCTURE TABLE		
STRUCTURE NAME	INVERT ELEVATION	RIM ELEVATION
A-0	INV. = 628.01	TOP = 639.8
A-1	INV. = 628.9	TOP = 637.0
A-2	INV. = 630.7	TOP = 638.0
A-3	INV. = 633.5	TOP = 639.0
B-1	INV. = 631.8	TOP = 638.0
B-2	INV. = 632.5	TOP = 638.0
B-3	INV. = 633.1	TOP = 639.0
C-1	INV. = 630.1	TOP = 637.0
D-1	INV. = 626.5	TOP = 630.0
D-2	INV. = 628.2	TOP = 632.0
E-1	INV. = 627.8	TOP = 632.2
E-2	INV. = 629.0	TOP = 633.0
E-3	INV. = 630.6	TOP = 634.0
E-4	INV. = 632.1	TOP = 635.0
F-1	INV. = 628.9	TOP = 634.5
F-2	INV. = 629.9	TOP = 633.0
F-3	INV. = 631.3	TOP = 635.0
F-4	INV. = 632.2	TOP = 636.0
G-1	INV. = 629.9	TOP = 636.0

CONSULTANTS

THIS BAR IS EQUAL TO 2" AT FULL SCALE (22X34)



ISSUED FOR BID

TAXIWAY BRAVO WEST
RELOCATION

OWNER



RICHARD B. RUSSELL
REGIONAL AIRPORT
FLOYD COUNTY, GEORGIA

MARK	DATE	DESCRIPTION

CMT PROJECT NO: 22004559-00
CAD DWG FILE: 22004559-CU-5.DWG
DESIGNED BY: JBH/JMM
DRAWN BY: JBH
CHECKED BY: JMM
APPROVED BY: MJR
COPYRIGHT: CRAWFORD, MURPHY & TILLY, INC. 2020

SHEET TITLE
**DRAINAGE DETAILS -
SHEET 2**

Path: K:\Richard\Russell\A\22004559-00_RMCD_D_TaxiwayWest\Railign\Draw\Sheet\22004559-CU-5.dwg
Date: Tuesday, June 2, 2020 11:20:19 AM

CONTROL POINT TABLE			
POINT	NORTHING	EASTING	DESCRIPTION
1	1583398.892	1995014.232	TAXIWAY B CENTERLINE
2	1583507.855	1994975.856	TAXIWAY B CENTERLINE
3	1583517.145	1994972.681	TAXIWAY B CENTERLINE
4	1583588.158	1994986.787	37' RADIUS CENTERPOINT
5	1583623.036	1994974.436	TAXIWAY B CENTERLINE
6	1583632.783	1995001.963	TAXIWAY B CENTERLINE
7	1583651.635	1995055.203	TAXIWAY B CENTERLINE
8	1583664.319	1995091.024	TAXIWAY B CENTERLINE
9	1583663.884	1995174.518	TAXIWAY B CENTERLINE
10	1583706.569	1995210.338	TAXIWAY B CENTERLINE
11	1583732.998	1995284.976	TAXIWAY B CENTERLINE
12	1583745.682	1995320.796	TAXIWAY B CENTERLINE
13	1583776.956	1995409.094	TAXIWAY B CENTERLINE
14	1583789.640	1995444.914	TAXIWAY B CENTERLINE
15	1583669.546	1995048.861	19' RADIUS CENTERPOINT
16	1583675.894	1995066.769	TAXIWAY R1 CENTERLINE
17	1583682.230	1995084.682	19' RADIUS CENTERPOINT
18	1583910.964	1994983.628	TAXIWAY R1 CENTERLINE
19	1583711.795	1995168.176	19' RADIUS CENTERPOINT
20	1583718.137	1995186.086	TAXIWAY R2 CENTERLINE
21	1583724.479	1995203.996	19' RADIUS CENTERPOINT
22	1583959.352	1995100.644	TAXIWAY R2 CENTERLINE
23	1583750.908	1995278.634	19' RADIUS CENTERPOINT
24	1583757.250	1995296.544	TAXIWAY R3 CENTERLINE
25	1583763.592	1995314.454	19' RADIUS CENTERPOINT
26	1583992.056	1995213.372	TAXIWAY R3 CENTERLINE
27	1583794.866	1995402.752	19' RADIUS CENTERPOINT
28	1583801.208	1995420.662	TAXIWAY R4 CENTERLINE
29	1583807.550	1995438.572	19' RADIUS CENTERPOINT
30	1584032.653	1995338.668	TAXIWAY R4 CENTERLINE
31	1583510.916	1994957.388	HOLD POSITON MAKRING

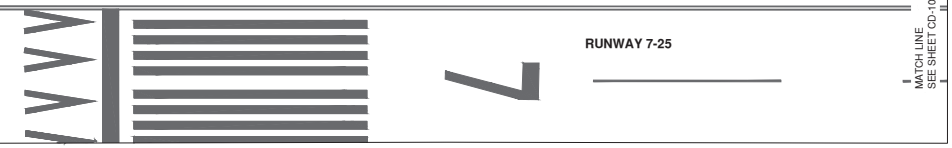
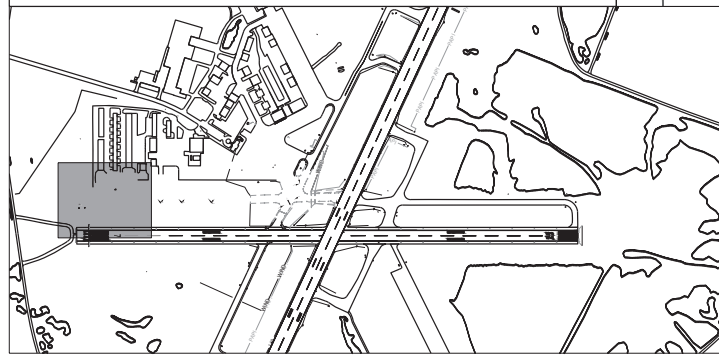
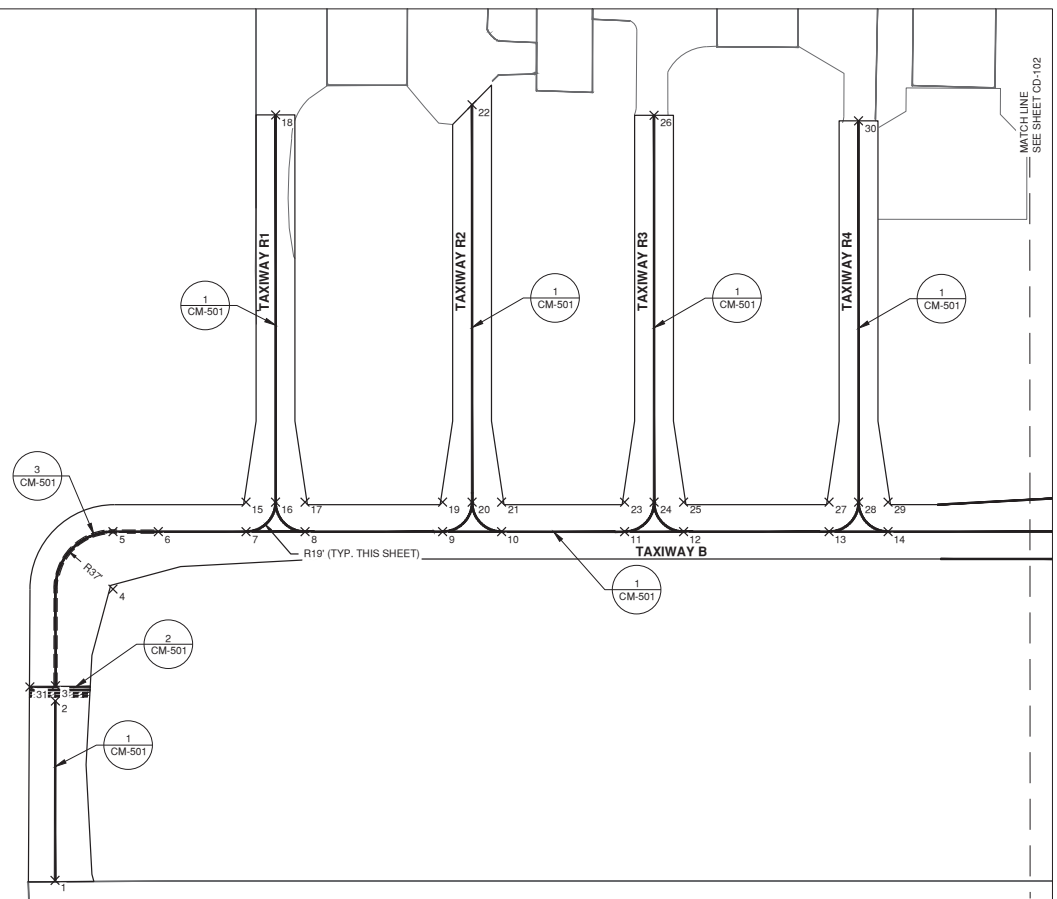

NOTES

- ALL PROPOSED PAVEMENT MARKINGS SHALL BE APPLIED IN TWO APPLICATIONS, UNLESS DIRECTED BY THE RPR.
 - THE FIRST APPLICATION WILL OCCUR PRIOR TO RE-OPENING PAVEMENTS TO AIR TRAFFIC. THIS TEMPORARY APPLICATION WILL BE APPLIED AT THE SPECIFIED MAXIMUM APPLICATION RATE FOR TEMPORARY PAINT AND WILL NOT CONTAIN REFLECTIVE MEDIA.
 - THE SECOND APPLICATION WILL OCCUR 30 DAYS AFTER RE-OPENING PAVEMENTS TO AIR TRAFFIC. THIS PERMANENT APPLICATION WILL BE APPLIED AT THE SPECIFIED MAXIMUM APPLICATION RATE FOR PERMANENT PAINT AND WILL CONTAIN REFLECTIVE MEDIA.
- BLACK PAVEMENT MARKINGS SHALL ONLY BE APPLIED FOR FINAL MARKING.

LEGEND

ENHANCED TAXIWAY CENTERLINE MARKING (CM-101 DETAIL 3)	
RUNWAY HOLD POSITION MARKING (CM-101 DETAIL 2)	
TAXIWAY CENTERLINE MARKING (CM-101 DETAIL 1)	

CONSULTANTS

SCALE: IN FEET
THIS BAR IS EQUAL TO 2" AT FULL SCALE (22X34)



ISSUED FOR BID
TAXIWAY BRAVO WEST
RELOCATION



RICHARD B. RUSSELL
REGIONAL AIRPORT
FLOYD COUNTY, GEORGIA

MARK	DATE	DESCRIPTION

CMT PROJECT NO: 22004559-00
CAD DWG FILE: 22004559-CM-1.DWG
DESIGNED BY: --
DRAWN BY: --
CHECKED BY: --
APPROVED BY: --
COPYRIGHT: CRAWFORD, MURPHY & TILLY, INC. 2026

SHEET TITLE
**PAVEMENT MARKING
- SHEET 1**

Path: K:\RichardRussell\A\22004559\00_RMG_D_TaxiwayWest\Realign\Draw\Sheets\22004559-CM-1.dwg
Date: Tuesday, June 2, 2026 11:20:29 AM

CONSULTANTS



SCALE: IN FEET
THIS BAR IS EQUAL TO 2" AT FULL SCALE (22X34)



ISSUED FOR BID
TAXIWAY BRAVO WEST
RELOCATION

OWNER



RICHARD B. RUSSELL
REGIONAL AIRPORT
FLOYD COUNTY, GEORGIA

MARK DATE DESCRIPTION

CMT PROJECT NO: 22004559-00
CAD DWG FILE: 22004559-CM-1.DWG
DESIGNED BY: --
DRAWN BY: --
CHECKED BY: --
APPROVED BY: --
COPYRIGHT: CRAWFORD, MURPHY & TILLY, INC. 2020

SHEET TITLE
PAVEMENT MARKING
- SHEET 2

SHEET 46 OF 81
CM-102

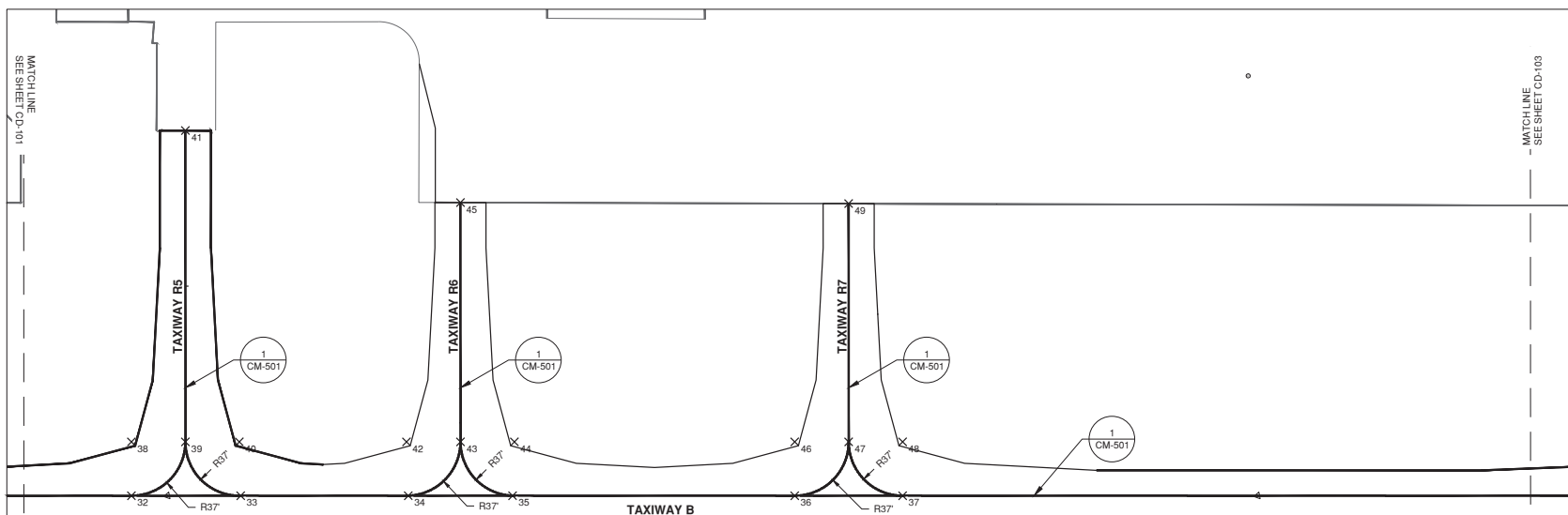

CONTROL POINT TABLE			
POINT	NORTHING	EASTING	DESCRIPTION
32	1583844.749	1995600.565	TAXIWAY B CENTERLINE
33	1583869.776	1995671.197	TAXIWAY B CENTERLINE
34	1583908.141	1995779.539	TAXIWAY B CENTERLINE
35	1583932.015	1995846.946	TAXIWAY B CENTERLINE
36	1583996.584	1996020.368	TAXIWAY B CENTERLINE
37	1584021.290	1996099.128	TAXIWAY B CENTERLINE
38	1583879.627	1995588.213	37' RADIUS CENTERPOINT
39	1583891.977	1995623.091	TAXIWAY R5 CENTERLINE
40	1583904.330	1995657.968	37' RADIUS CENTERPOINT

CONTROL POINT TABLE			
POINT	NORTHING	EASTING	DESCRIPTION
41	1584093.438	1995551.754	TAXIWAY R5 CENTERLINE
42	1583942.595	1995766.052	37' RADIUS CENTERPOINT
43	1583954.948	1995800.929	TAXIWAY R6 CENTERLINE
44	1583967.299	1995835.807	37' RADIUS CENTERPOINT
45	1584109.778	1995746.084	TAXIWAY R6 CENTERLINE
46	1584031.463	1996017.019	37' RADIUS CENTERPOINT
47	1584043.813	1996051.897	TAXIWAY R7 CENTERLINE
48	1584056.166	1996086.774	37' RADIUS CENTERPOINT
49	1584197.990	1995997.284	TAXIWAY R7 CENTERLINE

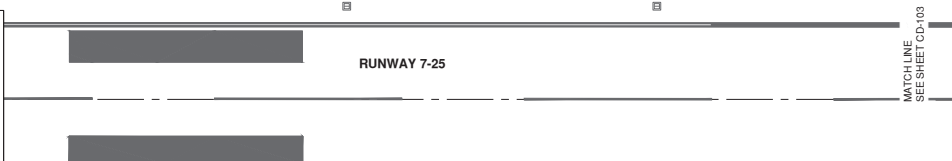
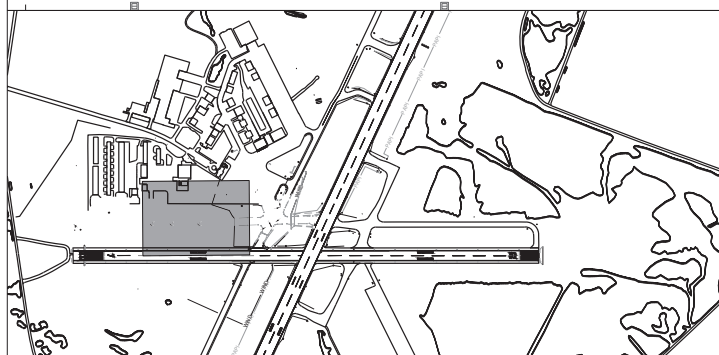

NOTES

- ALL PROPOSED PAVEMENT MARKINGS SHALL BE APPLIED IN TWO APPLICATIONS, UNLESS DIRECTED BY THE RPI.
 - THE FIRST APPLICATION WILL OCCUR PRIOR TO RE-OPENING PAVEMENTS TO AIR TRAFFIC. THIS TEMPORARY APPLICATION WILL BE APPLIED AT THE SPECIFIED MAXIMUM APPLICATION RATE FOR TEMPORARY PAINT AND WILL NOT CONTAIN REFLECTIVE MEDIA.
 - THE SECOND APPLICATION WILL OCCUR 30 DAYS AFTER RE-OPENING PAVEMENTS TO AIR TRAFFIC. THIS PERMANENT APPLICATION WILL BE APPLIED AT THE SPECIFIED MAXIMUM APPLICATION RATE FOR PERMANENT PAINT AND WILL CONTAIN REFLECTIVE MEDIA.
- BLACK PAVEMENT MARKINGS SHALL ONLY BE APPLIED FOR FINAL MARKING.

LEGEND

TAXIWAY CENTERLINE MARKING
(CM-101 DETAIL 1)

CONSULTANTS



ISSUED FOR BID
TAXIWAY BRAVO WEST
RELOCATION

OWNER



RICHARD B. RUSSELL
REGIONAL AIRPORT
FLOYD COUNTY, GEORGIA

MARK	DATE	DESCRIPTION

CMT PROJECT NO: 22004559-00
CAD DWG FILE: 22004559-CM-1.DWG
DESIGNED BY: --
DRAWN BY: --
CHECKED BY: --
APPROVED BY: --
COPYRIGHT: CRAWFORD, MURPHY & TILLY, INC. 2026

SHEET TITLE
PAVEMENT MARKING
- SHEET 3

SHEET 47 OF 81

CONTROL POINT TABLE

POINT	NORTHING	EASTING	DESCRIPTION
50	1584197.260	1996596.039	TAXIWAY B CENTERLINE
51	1584241.807	1996721.884	TAXIWAY A TAXIWAY B INTERSECTION
52	1584286.377	1996847.730	TAXIWAY B CENTERLINE
53	1584357.076	1996822.697	75' RADIUS CENTERPOINT
54	1584298.337	1996657.123	75' RADIUS CENTERPOINT
55	1584185.168	1996786.595	75' RADIUS CENTERPOINT
56	1584126.524	1996621.073	75' RADIUS CENTERPOINT
57	1584117.172	1996695.899	TAXIWAY A CENTERLINE
58	1584056.912	1996683.488	TAXIWAY A CENTERLINE
59	1584370.774	1996673.324	75' RADIUS CENTERPOINT
60	1584517.869	1996703.162	75' RADIUS CENTERPOINT
61	1584452.170	1996627.927	TAXIWAY R8 CENTERLINE
62	1584443.974	1996689.873	TAXIWAY R8 CENTERLINE
63	1584569.190	1996787.021	TAXIWAY A CENTERLINE
69	1584388.400	1997135.606	TAXIWAY B CENTERLINE
70	1584306.372	1997128.907	75' RADIUS CENTERPOINT
71	1584381.125	1997134.982	TAXIWAY B CENTERLINE
72	1584377.071	1997103.874	TAXIWAY B CENTERLINE
73	1584368.488	1996748.550	TAXIWAY A CENTERLINE
74	1584476.715	1996771.162	TAXIWAY A CENTERLINE
76	1584281.958	1996730.307	TAXIWAY A CENTERLINE
77	1584201.681	1996713.467	TAXIWAY A CENTERLINE
78	1584227.643	1996682.154	TAXIWAY B CENTERLINE
79	1584255.508	1996760.547	ENHANCED MARKING POINT
80	1584489.898	1996772.866	TAXIWAY A CENTERLINE
81	1584195.059	1996589.896	ENHANCED MARKING POINT
82	1584126.524	1996696.108	ENHANCED MARKING POINT
83	1584127.069	1996698.276	ENHANCED MARKING POINT
84	1584274.534	1996728.749	ENHANCED MARKING POINT
86	1584274.061	1996812.956	ENHANCED MARKING POINT
87	1584282.829	1996812.130	ENHANCED MARKING POINT
88	1584293.803	1996952.163	HOLD POSITION MARKING
89	1584327.622	1996964.266	TAXIWAY B CENTERLINE
90	1584324.237	1996954.636	ENHANCED MARKING POINT
91	1584380.479	1997138.213	TAXIWAY B LEAD IN LINE
92	1584297.117	1997197.716	TAXIWAY B LEAD IN LINE
93	1584098.040	1997178.524	TAXIWAY B LEAD IN LINE
94	1584443.174	1997288.687	TAXIWAY B LEAD IN LINE
96	1584462.718	1997213.680	TAXIWAY B LEAD IN LINE
97	1584661.795	1997232.871	TAXIWAY B LEAD IN LINE
98	1584470.011	1997138.031	TAXIWAY B LEAD IN LINE

LEGEND

ENHANCED TAXIWAY CENTERLINE MARKING (CM-101 DETAIL 3)	
RUNWAY HOLD POSITION MARKING (CM-101 DETAIL 2)	
TAXIWAY CENTERLINE MARKING (CM-101 DETAIL 1)	

NOTES

- ALL PROPOSED PAVEMENT MARKINGS SHALL BE APPLIED IN TWO APPLICATIONS, UNLESS DIRECTED BY THE RFP.
 - THE FIRST APPLICATION WILL OCCUR PRIOR TO RE-OPENING PAVEMENTS TO AIR TRAFFIC. THIS TEMPORARY APPLICATION WILL BE APPLIED AT THE SPECIFIED MAXIMUM APPLICATION RATE FOR TEMPORARY PAINT AND WILL NOT CONTAIN REFLECTIVE MEDIA.
 - THE SECOND APPLICATION WILL OCCUR 30 DAYS AFTER RE-OPENING PAVEMENTS TO AIR TRAFFIC. THIS PERMANENT APPLICATION WILL BE APPLIED AT THE SPECIFIED MAXIMUM APPLICATION RATE FOR PERMANENT PAINT AND WILL CONTAIN REFLECTIVE MEDIA.
- BLACK PAVEMENT MARKINGS SHALL ONLY BE APPLIED FOR FINAL MARKING.

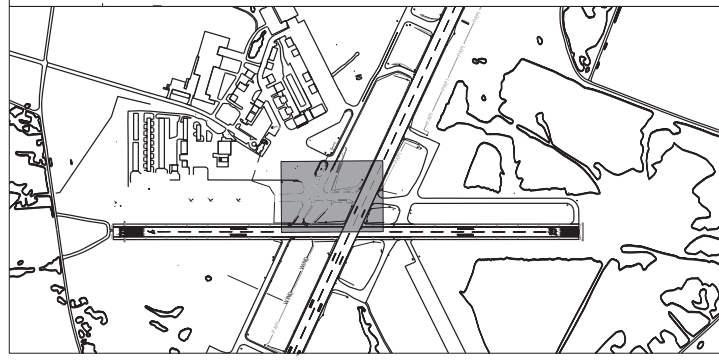
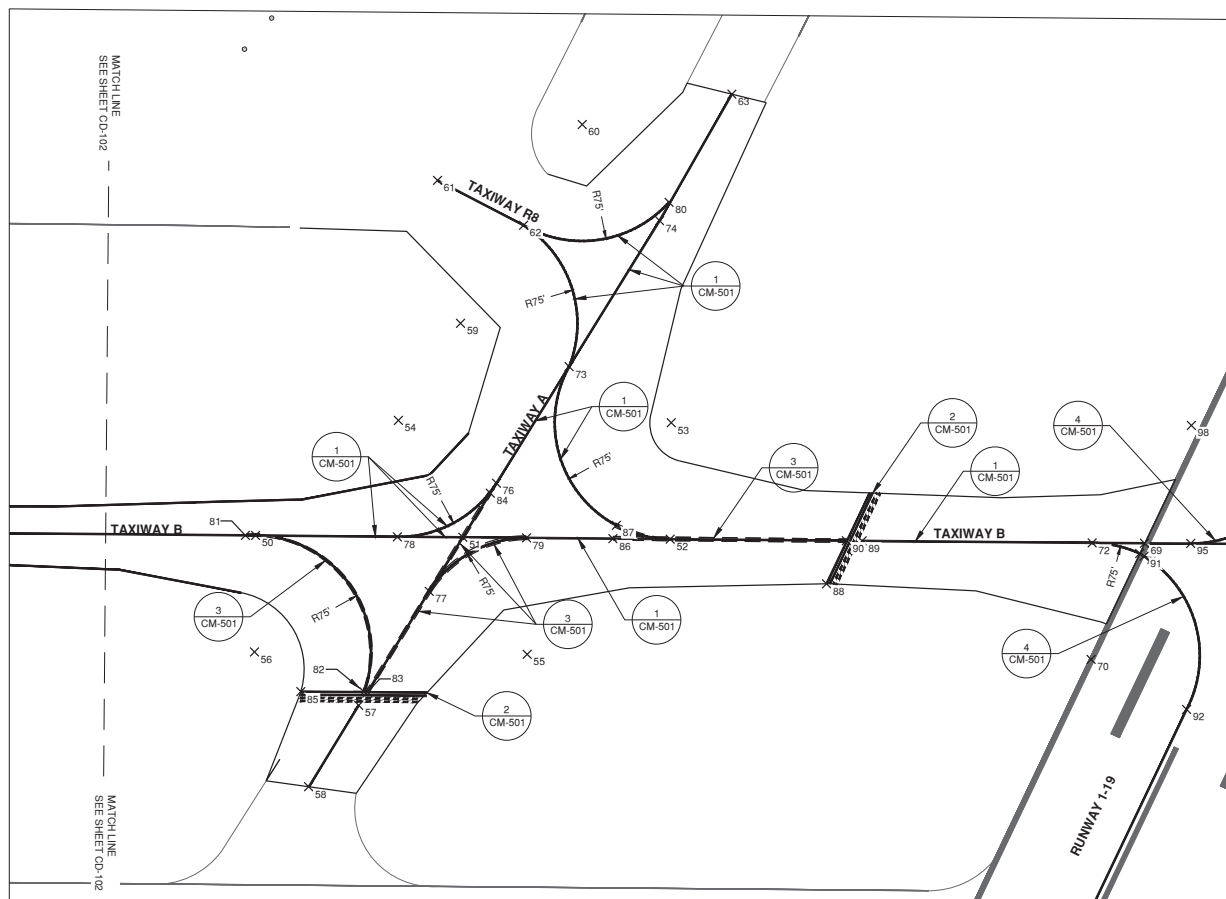

Path: K:\RichardRussell\A\22004559-00_RMD_D_TaxiwayWest\Railign\Draw\Sheet\22004559-CM-1.dwg
Date: Tuesday, June 2, 2026 11:20:46 AM

CONSULTANTS

THIS BAR IS EQUAL TO 2" AT FULL SCALE (22X34)



ISSUED FOR BID

TAXIWAY BRAVO WEST
RELOCATION

OWNER



RICHARD B. RUSSELL
REGIONAL AIRPORT
FLOYD COUNTY, GEORGIA

MARK	DATE	DESCRIPTION

CMT PROJECT NO:	22004559-00
CAD DWG FILE:	22004559-CM-5.DWG
DESIGNED BY:	-
DRAWN BY:	-
CHECKED BY:	-
APPROVED BY:	-
COPYRIGHT:	CRAWFORD, MURPHY & TILLY, INC. 2020

SHEET TITLE
**PAVEMENT MARKING
DETAILS**

CM-501
SHEET 48 OF 81

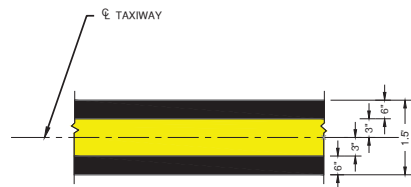

1 TAXIWAY CENTERLINE MARKING DETAIL
NOT TO SCALE

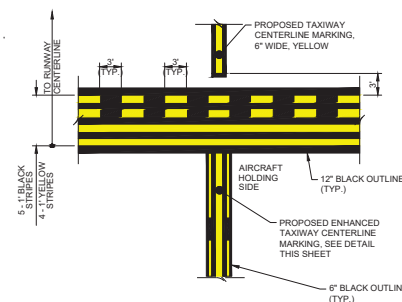

NOTES:
NUMBERS LETTERS AND SYMBOLS SHALL CONFORM IN APPEARANCE TO FAA
ADVISORY CIRCULAR 150-5340-1M APPENDIX B.

2 RUNWAY HOLD POSITION
MARKING DETAIL
NOT TO SCALE

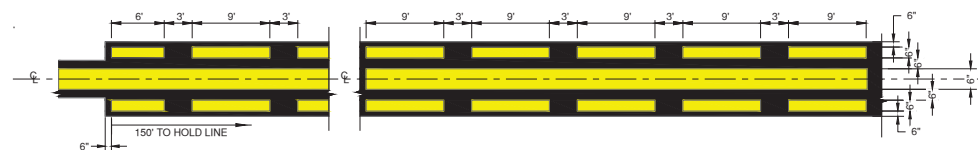

3 ENHANCED TAXIWAY CENTERLINE MARKING DETAIL
NOT TO SCALE

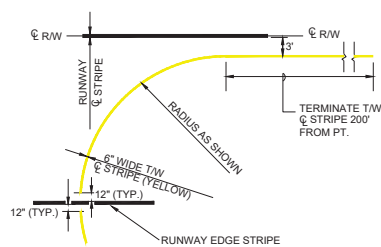

4 TAXIWAY TURN RADIUS DETAIL
NOT TO SCALE

EXISTING UTILITIES LEGEND

EXISTING PAPI CIRCUIT	— PAPI —	EXISTING REIL CIRCUIT	— REIL —
EXISTING CATCH BASIN		EXISTING STORM SEWER	— ST —
EXISTING FIBER OPTIC HANDHOLE		FIBER OPTIC CABLE	— FO —

AIRFIELD LIGHTING FIXTURE AND STRUCTURE LEGEND

EXISTING	PROPOSED	FIXTURE DESCRIPTION
	N/A	L-862(L), ELEVATED RUNWAY LIGHT. 'X' INDICATES COLOR, REFER TO FIXTURE COLOR TABLE FOR LENS COLOR
		L-861(L), ELEVATED RUNWAY LIGHT. 'X' INDICATES COLOR, REFER TO FIXTURE COLOR TABLE FOR LENS COLOR
N/A		L-850(C), IN-PAVEMENT RUNWAY LIGHT. 'X' INDICATES COLOR REFER TO FIXTURE COLOR TABLE FOR LENS COLOR
		L-861T(L) TAXIWAY EDGE LIGHT
		L-858(L), LED, GUIDANCE SIGN
		ELECTRICAL HANDHOLE
		ELECTRICAL SPLICE CAN
N/A		JUNCTION CAN PLAZA. 'X' INDICATES THE NUMBER OF CANS
N/A		L-853 STAKE MOUNTED RETROREFLECTOR

FIXTURE COLOR SCHEDULE

COLOR SYMBOL	LENS COLOR
G	GREEN
W	WHITE
Y	YELLOW
R	RED
B	BLANK
O	OBSCURED
UNI	UNIDIRECTIONAL

AIRFIELD LIGHTING CONDUIT LEGEND

EXISTING	PROPOSED	CONDUIT DESCRIPTION
		DUCT BANK: X = NUMBER OF CONDUITS Y = SIZE OF CONDUITS (CE) = CONCRETE ENCASED (DB) = DIRECT BURIED (DD) = DIRECTIONALLY DRILLED
		2" PVC CONDUIT

GENERAL NOTES

- ALL ELECTRICAL WORK SHALL BE IN ACCORDANCE WITH THE LATEST ADOPTED VERSION OF THE NATIONAL ELECTRICAL CODE (NEC), THE NATIONAL ELECTRICAL SAFETY CODE, FAA ADVISORY CIRCULARS AND ORDERS, AND APPLICABLE LOCAL BUILDING CODES, LAWS, AND ORDINANCES.
- THE CONTRACTOR SHALL OBTAIN AND PAY FOR ALL REQUIRED PERMITS, LICENSES, INSPECTIONS, FEES, AND APPROVALS.
- THE CONTRACTOR SHALL PROVIDE ALL LABOR, MATERIALS, AND EQUIPMENT TO REMOVE, RELOCATE, MODIFY AND INSTALL THE ELECTRICAL SYSTEMS AS INDICATED ON THE DRAWINGS. ITEMS NOT SHOWN BUT NECESSARY FOR COMPLETION OF THE WORK SHALL BE INCLUDED AND INCIDENTAL TO BID ITEMS WITH NO SEPARATE PAYMENT.
- ALL ITEMS ARE NEW UNLESS SPECIFICALLY NOTED OTHERWISE. NEW MATERIALS SHALL BE U.L. LISTED.
- ALL MATERIALS SCHEDULED FOR REMOVAL SUCH AS EXISTING LIGHTS, COVERS, TRANSFORMERS, ETC. WHICH ARE DEEMED SALVAGEABLE BY THE AIRPORT SHALL BE DELIVERED TO THE LOCATION ON AIRPORT PROPERTY AS INDICATED BY THE OWNER'S REPRESENTATIVE. ALL NON-SALVAGEABLE MATERIALS REMOVED SUCH AS STRUCTURES, CONCRETE FOUNDATIONS, CABLE, CONDUIT, LIGHT BASES, ETC. SHALL BE REMOVED FROM THE SITE AND LEGALLY DISPOSED OF BY THE CONTRACTOR IN ACCORDANCE WITH APPLICABLE LAWS AND ENVIRONMENTAL REGULATIONS.
- THE LOCATIONS OF UTILITIES, DUCT BANKS, AND CONDUITS SHOWN ON THE PLANS ARE APPROXIMATE AND SHALL NOT BE SCALED FOR EXACT LOCATIONS. NOT ALL UTILITIES MAY BE SHOWN. IT SHALL BE THE RESPONSIBILITY OF THE CONTRACTOR TO CONTACT THE APPROPRIATE UTILITY/AGENCY PRIOR TO STARTING WORK FOR THE LOCATION OF EXISTING UTILITIES AND TO ALLOW THEM TIME TO PROPERLY LOCATE ALL UTILITIES. ANY INTERRUPTION OF AN EXISTING SYSTEM OR UTILITY SERVICE SHALL BE COORDINATED AND APPROVED BY THE AIRPORT AND/OR RPR.
- ALL EXISTING SYSTEMS AND UTILITIES TO REMAIN SHALL BE PROTECTED FROM DAMAGE. THE CONTRACTOR SHALL BE RESPONSIBLE FOR ANY DAMAGED SYSTEM OR UTILITY AND SHALL REPAIR OR MAKE REPAIRS IMMEDIATELY AT THEIR OWN EXPENSE, IN ACCORDANCE WITH THE AUTHORITY, AGENCY OR UTILITY HAVING JURISDICTION. DAMAGED SYSTEMS OR UTILITIES SHALL BE IMMEDIATELY REPORTED TO THE OWNER'S REPRESENTATIVE.
- THE CONTRACTOR SHALL UTILIZE A LOCATE SERVICE AS WELL AS HAVE A CABLE TRACER AVAILABLE TO LOCATE THE EXISTING CABLES. ALL EXCAVATION WITHIN FOUR FEET OF ANY UNDERGROUND UTILITY TO REMAIN SHALL BE PERFORMED BY HAND DIGGING METHODS.
- THE IDENTITY AND ROUTING OF ALL CABLES SHOWN ON THE PLANS SHALL BE VERIFIED IN THE FIELD. ANY DISCREPANCY SHALL BE BROUGHT TO THE ATTENTION OF THE OWNER'S REPRESENTATIVE AND RECORDED IN THE AS-BUILT DRAWINGS TO PROVIDE AN ACCURATE RECORD OF CONDITIONS. THESE PLANS DO NOT PURPORT TO SHOW ALL EXISTING CABLES AND CONCEALED UTILITIES WHICH WILL REQUIRE STAKE OUT PRIOR TO CONSTRUCTION. CONTRACTOR SHALL VERIFY EXISTING CIRCUIT ROUTING PRIOR TO COMMENCING WORK.
- ALL TAXIWAY AND RUNWAY EDGE LIGHTS SHALL BE INSTALLED 10 FEET FROM THE EDGE OF PAVEMENT MARKING. ALL TAXIWAY AND RUNWAY EDGE LIGHTS LOCATED ON STRAIGHT SECTIONS SHALL BE LOCATED SUCH THAT A LINE BETWEEN LIGHTS ON OPPOSITE SIDES IS PERPENDICULAR TO THE CENTERLINE.
- DEWATERING FOR THE INSTALLATION OF STRUCTURES, FOUNDATIONS, DUCT BANKS, AND CONDUIT IS INCIDENTAL TO THE RESPECTIVE PAY ITEM. THE CONTRACTOR SHALL BE RESPONSIBLE TO PAY FOR AND OBTAIN ANY AND ALL PERMITS REQUIRED FOR DEWATERING.
- THE PROJECT PAY ITEMS ARE PROVIDED TO BE INCLUSIVE OF ALL WORK PERFORMED AS SHOWN IN THE PLANS. ALL WORK TO BE IDENTIFIED WITH A SPECIFIC PAY ITEM IS TO BE CONSIDERED REQUIRED WORK TO COMPLETE THE PROJECT AND IS TO BE SUBSIDIARY TO THE COST OF PROJECT PAY ITEMS PROVIDED.
- ITEMS SHOWN SCREENED (LIGHT) ARE EXISTING ITEMS AND ITEMS SHOWN IN SOLID (BOLD) ARE ITEMS TO BE MODIFIED, REMOVED, OR INSTALLED UNDER THIS CONTRACT UNLESS NOTED OTHERWISE.
- IT SHALL BE THE CONTRACTOR'S RESPONSIBILITY TO DETERMINE THAT ALL AIRFIELD LIGHTING CIRCUITS, EXCEPT THOSE THAT ARE SERVING CLOSED TAXIWAYS OR RUNWAYS, ARE OPERATIONAL USING TOWER AND/OR VAULT CONTROLS AT THE END OF EACH WORK DAY AND SHALL SO CERTIFY TO THE OWNER'S REPRESENTATIVE BEFORE LEAVING THE SITE EACH DAY. ALL INOPERABLE CIRCUITS REQUIRED FOR THE OPERATION OF THE AIRPORT SHALL BE IMMEDIATELY RESTORED. THE CONTRACTOR SHALL BE RESPONSIBLE FOR ALL COSTS, INCLUDING REPAIRS MADE BY AIRPORT PERSONNEL.
- THE CONTRACTOR SHALL COORDINATE ALL WORK WITH THE SAFETY AND PHASING PLANS.
- THE CONTRACTOR SHALL COMPLY WITH THE AIRPORT MAINTENANCE "LOCK-OUT/TAG-OUT" PROCEDURES AND NFPA 70E.
- FOR EVERY LIGHT FIXTURE AND SIGN INSTALLED UNDER THIS CONTRACT, THE CONTRACTOR SHALL OBTAIN THE EXACT LOCATION VIA SURVEY AND BE APPROVED BY THE OWNER'S REPRESENTATIVE PRIOR TO INSTALLATION.
- THE CONTRACTOR SHALL CONDUCT INSULATION RESISTANCE TO GROUND (MEGGER) TESTS ON EACH CIRCUIT AFFECTED BY THIS WORK BEFORE COMMENCING WORK ON THAT CIRCUIT. THE CONTRACTOR SHALL PREPARE AND PROVIDE TO THE OWNER'S REPRESENTATIVE A WRITTEN REPORT, BY CIRCUIT, OF THESE RESULTS. THE CONTRACTOR SHALL REPEAT THIS TEST ON EACH AFFECTED CIRCUIT AFTER COMPLETION OF THE WORK. RESULTS OF BOTH TESTS SHALL BE PROVIDED TO THE OWNER'S REPRESENTATIVE.
- ALL ITEMS SHALL BE SHOWN IN ACTUAL LOCATION INSTALLED. ALL UNDERGROUND DUCTS, CONDUITS, DRAINS, GROUND GRIDS, FORCE MAINS, ETC. (ALL UNDERGROUND UTILITIES) INSTALLED BY THE CONTRACTOR OR LOCATED BY THE CONTRACTOR DURING CONSTRUCTION OF THIS PROJECT SHALL BE SURVEYED. THE DATA SHALL BE SUFFICIENTLY ACCURATE TO LOCATE THE UTILITY AT A LATER DATE. THE DATA SHALL INCLUDE NORTH-SOUTH AND EAST-WEST COORDINATES AND AN ELEVATION. ALL STRUCTURES INSTALLED BY THE CONTRACTOR SHALL BE SURVEYED. THE CENTER OF THE STRUCTURE SHALL BE LOCATED BY A NORTH-SOUTH AND EAST-WEST COORDINATE AND ELEVATION. CHANGE THE EQUIPMENT SCHEDULES TO AGREE WITH ITEMS ACTUALLY FURNISHED. AT THE END OF THE PROJECT, ALL CHANGES SHALL BE TRANSFERRED TO A SET OF REPRODUCIBLE DESIGN DRAWINGS MARKED "AS-BUILT" AND DATED AND STAMPED BY THE ELECTRICAL CONTRACTOR.
- BY SUBMITTING A BID, THE CONTRACTOR ASSURES THE OWNER THAT THE PRODUCT(S) PROVIDED ARE NOT 'END OF LIFE' OR 'END OF PRODUCT LINE' ITEMS AND THAT SPARE PARTS SHALL BE AVAILABLE TO THE OWNER FOR A PERIOD OF AT LEAST 10 YEARS BEYOND THE WARRANTY PERIOD. THE CONTRACTOR AGREES TO REPLACE ANY ITEM OF WHICH PARTS ARE NOT AVAILABLE FOR THE SPECIFIED 10 YEAR PERIOD WITH NEW MANUFACTURED PRODUCT OF EQUIVALENT OR BETTER FUNCTION AND TYPE.
- ONLY THIRD PART CERTIFIED MANUFACTURERS, LISTED IN AC 150-5345-53, APPENDIX 3 ADDENDUM (AS REQUIRED) AND MEETING THE BUY AMERICAN PREFERENCE REQUIREMENTS CAN PROVIDE EQUIPMENT AND MATERIALS SPECIFIED IN THE CONTRACT DOCUMENTS. DOCUMENTATION CERTIFYING COMPLIANCE WITH THE BUY AMERICAN PREFERENCE RULES FOR AIRPORT IMPROVEMENT PROGRAM (AIP) CITED IN 49 USC §50101 SHALL BE INCLUDED WITH EACH EQUIPMENT AND MATERIAL SUBMITTAL.

CIRCUIT IDENTIFICATION

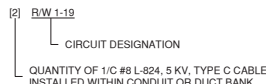

CIRCUIT IDENTIFICATION NOTES:

- DARK TEXT INDICATES CABLE TO BE FURNISHED AND INSTALLED
- LIGHT TEXT INDICATES EXISTING CABLE TO REMAIN.

GROUNDING

- GROUND ALL NON-CURRENT-CARRYING METAL PARTS OF ELECTRICAL EQUIPMENT BY USING CONDUCTORS SIZED AND ROUTED PER NFPA 70 (NEC) 2023, ARTICLE 250.
- ALL GROUND CONNECTIONS TO GROUND RODS, BUSSES, PANELS, ETC., SHALL BE MADE WITH PRESSURE TYPE SOLDERLESS LUGS AND GROUND CLAMPS. SOLDERED OR BOLT AND WASHER TYPE CONNECTIONS ARE NOT ACCEPTABLE. CLEAN ALL METAL SURFACE BEFORE MAKING GROUND CONNECTIONS. EXOTHERMIC WELDS ARE THE PREFERRED METHOD OF CONNECTION TO A GROUND ROD.
- THE RESISTANCE TO GROUND OF THE VAULT GROUNDING SYSTEM WITH THE COMMERCIAL POWER LINE NEUTRAL DISCONNECTED SHALL NOT EXCEED 10 OHMS.
- THE RESISTANCE TO GROUND OF THE COUNTERPOISE SYSTEM, OR AT ISOLATION LOCATIONS, SUCH AS AIRPORT BEACON SHALL NOT EXCEED 25 OHMS.



CONSULTANTS

THIS BAR IS EQUAL TO 2" AT FULL SCALE (22X34)



ISSUED FOR BID

TAXIWAY BRAVO WEST RELOCATION

OWNER



RICHARD B. RUSSELL
REGIONAL AIRPORT
FLOYD COUNTY, GEORGIA

MARK	DATE	DESCRIPTION

CMT PROJECT NO: 22004559-00

CAD DWG FILE: 22004559-EL-1.DWG

DESIGNED BY: JBH/JMM

DRAWN BY: JBH

CHECKED BY: JMM

APPROVED BY: MJR

COPYRIGHT: CRAWFORD, MURPHY & TILLY, INC. 2026

SHEET TITLE

ELECTRICAL LAYOUT
LEGEND AND NOTES

EL-100
SHEET 49 OF 81

CONSULTANTS



0 40 80
SCALE: IN FEET
THIS BAR IS EQUAL TO 2" AT FULL SCALE (22X34)



ISSUED FOR BID

TAXIWAY BRAVO WEST
RELOCATION

OWNER



RICHARD B. RUSSELL
REGIONAL AIRPORT
FLOYD COUNTY, GEORGIA

MARK	DATE	DESCRIPTION

CMT PROJECT NO.: 22004559-00
CAD DWG FILE: 22004559-EL-1.DWG
DESIGNED BY: JBH/JMM
DRAWN BY: JBH
CHECKED BY: JMM
APPROVED BY: MJR
COPYRIGHT: CRAWFORD, MURPHY & TILLY, INC. 2026

SHEET TITLE
**ELECTRICAL LAYOUT
PLAN - SHEET 1**

EL-101
SHEET 50 OF 81

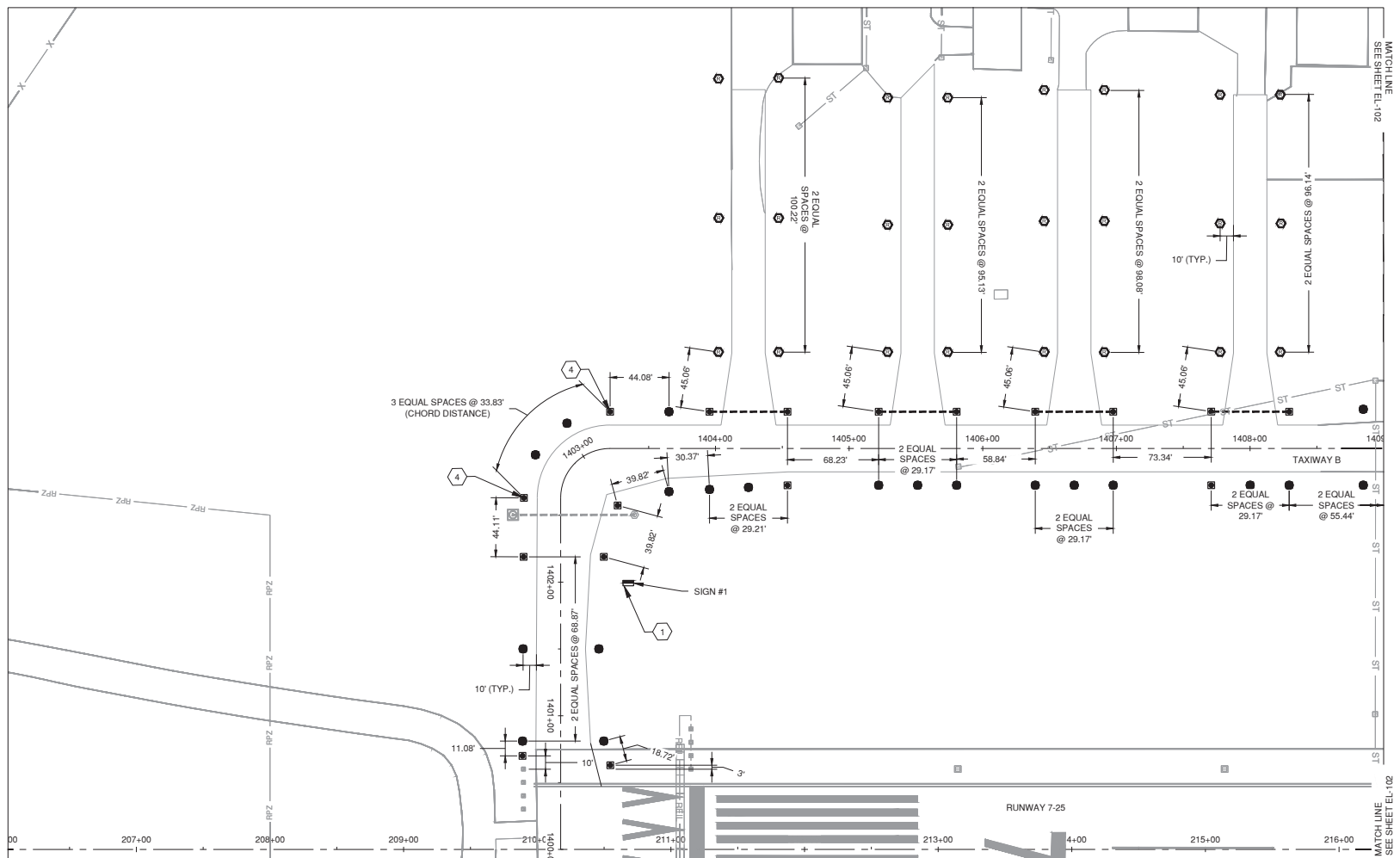

SHEET NOTES

- REFER TO DRAWING EL-500 FOR INFORMATION TO LOCATE SIGNS.
- REFER TO DRAWING EL-100 FOR ELECTRICAL LEGEND AND GENERAL NOTES.

KEYED NOTES

- INSTALL RELOCATED SIGN AND TIE EXISTING CIRCUIT TO RELOCATED SIGN.
- EXTEND EXISTING CONCRETE ENCASED DUCT BANK.
- CONNECT PROPOSED CONDUIT TO EXISTING LIGHT BASE, SIGN OR HANDHOLE. IF NO CONDUIT HUB IS PRESENT, CORE DRILL THE EXISTING STRUCTURE AND SEAL WITH NON-SHRINK GROUT. THIS WORK SHALL BE CONSIDERED INCIDENTAL TO THE CONDUIT INSTALLATION.
- INSTALL LIGHT AT THE POINT OF TANGENT.

KEYMAP



CONSULTANTS



ISSUED FOR BID

TAXIWAY BRAVO WEST
RELOCATION

OWNER



RICHARD B. RUSSELL
REGIONAL AIRPORT
FLOYD COUNTY, GEORGIA

MARK	DATE	DESCRIPTION

CMT PROJECT NO:	22004559-00
CAD DWG FILE:	22004559-EL-1.DWG
DESIGNED BY:	JBH/JMM
DRAWN BY:	JBH
CHECKED BY:	JMM
APPROVED BY:	MJR
COPYRIGHT:	CRAWFORD, MURPHY & TILLY, INC. 2026

SHEET TITLE
**ELECTRICAL LAYOUT
PLAN - SHEET 2**

EL-102
SHEET 51 OF 81

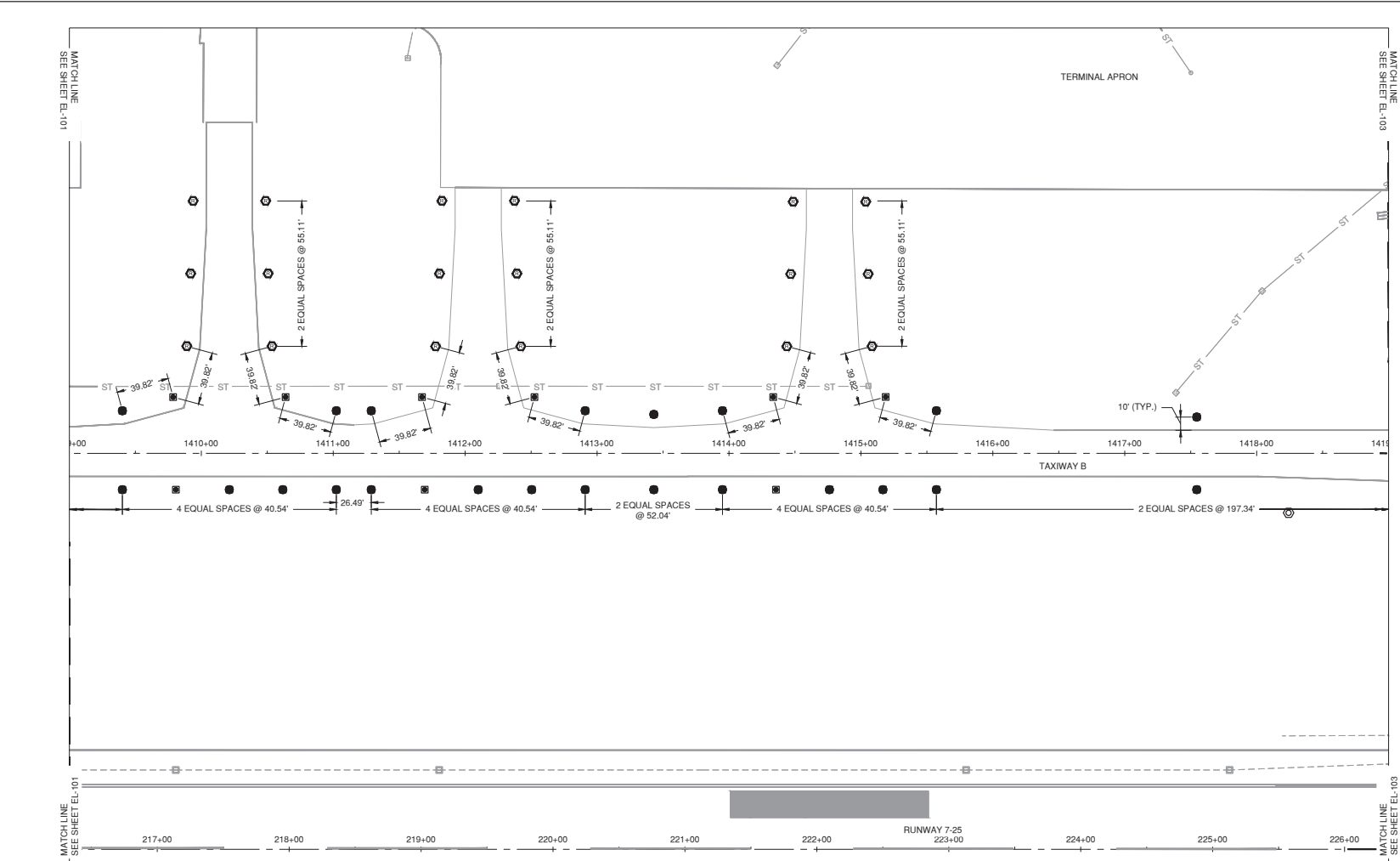

SHEET NOTES

- REFER TO DRAWING EL-500 FOR INFORMATION TO LOCATE SIGNS.
- REFER TO DRAWING EL-100 FOR ELECTRICAL LEGEND AND GENERAL NOTES.

KEYED NOTES

- INSTALL RELOCATED SIGN AND TIE EXISTING CIRCUIT TO RELOCATED SIGN.
- EXTEND EXISTING CONCRETE ENCASED DUCT BANK.
- CONNECT PROPOSED CONDUIT TO EXISTING LIGHT BASE, SIGN OR HANDHOLE. IF NO CONDUIT HUB IS PRESENT, CORE-DRILL THE EXISTING STRUCTURE AND SEAL WITH NON-SHRINK GROUT. THIS WORK SHALL BE CONSIDERED INCIDENTAL TO THE CONDUIT INSTALLATION.
- INSTALL LIGHT AT THE POINT OF TANGENT.

KEYMAP

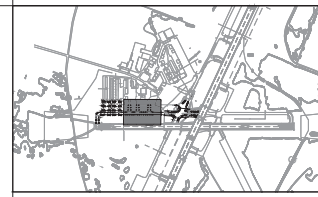

Path: K:\RichardRussell\A\22004559-00_RMG_D_TaxiwayWestReloc\Draw\Sheet\22004559-EL-1.dwg
 Date: Tuesday, June 2, 2026 11:54:22 AM

CONSULTANTS



ISSUED FOR BID
TAXIWAY BRAVO WEST
RELOCATION

OWNER



RICHARD B. RUSSELL
REGIONAL AIRPORT
FLOYD COUNTY, GEORGIA

MARK	DATE	DESCRIPTION

CMT PROJECT NO.: 22004559-00
CAD DWG FILE: 22004559-EL-1.DWG
DESIGNED BY: JBH/JMM
DRAWN BY: JBH
CHECKED BY: JMM
APPROVED BY: MJR
COPYRIGHT: CRAWFORD, MURPHY & TILLY, INC. 2024

SHEET TITLE
**ELECTRICAL LAYOUT
PLAN - SHEET 4**

EL-104
SHEET 53 OF 81

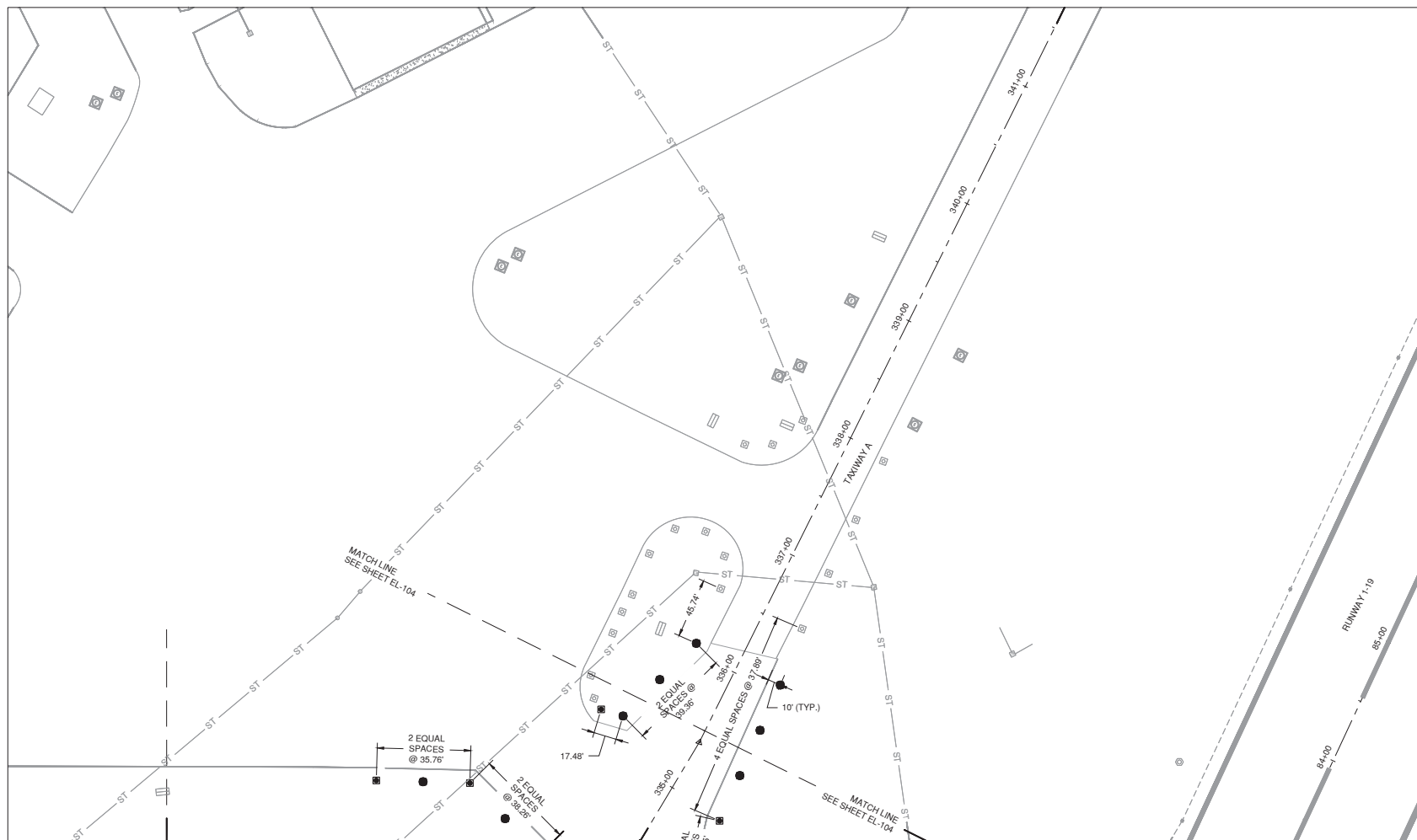

SHEET NOTES

- REFER TO DRAWING EL-509 FOR INFORMATION TO LOCATE SIGNS.
- REFER TO DRAWING EL-100 FOR ELECTRICAL LEGEND AND GENERAL NOTES.

KEYED NOTES

- INSTALL RELOCATED SIGN AND TIE EXISTING CIRCUIT TO RELOCATED SIGN.
- EXTEND EXISTING CONCRETE ENCASED DUCT BANK.
- CONNECT PROPOSED CONDUIT TO EXISTING LIGHT BASE, SIGN OR HANDHOLE. IF NO CONDUIT HUB IS PRESENT, CORE-DRILL THE EXISTING STRUCTURE AND SEAL WITH NON-SHRINK GROUT. THIS WORK SHALL BE CONSIDERED INCIDENTAL TO THE CONDUIT INSTALLATION.
- INSTALL LIGHT AT THE POINT OF TANGENT.

KEYMAP

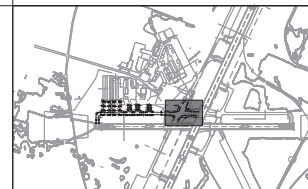

Path: K:\RichardRussell\A\22004559-00_RMD_D_TaxiwayWest\Runway\Draw\Sheet\22004559-EL-1.dwg
 Date: Tuesday, June 2, 2026 11:54:42 AM

CONSULTANTS



ISSUED FOR BID

TAXIWAY BRAVO WEST
RELOCATION

OWNER



RICHARD B. RUSSELL
REGIONAL AIRPORT
FLOYD COUNTY, GEORGIA

MARK	DATE	DESCRIPTION

CMT PROJECT NO.: 22004559-00
CAD DWG FILE: 22004559-EL-1.DWG
DESIGNED BY: JBH/JMM
DRAWN BY: JBH
CHECKED BY: JMM
APPROVED BY: MJR
COPYRIGHT: CRAWFORD, MURPHY & TILLY, INC. 2025

SHEET TITLE
**ELECTRICAL CIRCUIT
PLAN - SHEET 1**

54 OF 81
SHEET 54 OF 81



SHEET NOTES

- REFER TO DRAWING EL-500 FOR INFORMATION TO LOCATE SIGNS.
- REFER TO DRAWING EL-100 FOR ELECTRICAL LEGEND AND GENERAL NOTES.

KEYED NOTES

- INSTALL RELOCATED SIGN AND TIE EXISTING CIRCUIT TO RELOCATED SIGN.
- EXTEND EXISTING CONCRETE ENCASED DUCT BANK.
- CONNECT PROPOSED CONDUIT TO EXISTING LIGHT BASE, SIGN OR HANDHOLE. IF NO CONDUIT HUB IS PRESENT, CORE-DRILL THE EXISTING STRUCTURE AND SEAL WITH NON-SHRINK GROUT. THIS WORK SHALL BE CONSIDERED INCIDENTAL TO THE CONDUIT INSTALLATION.
- INSTALL LIGHT AT THE POINT OF TANGENT.

KEYMAP

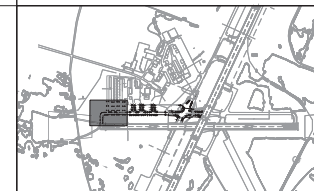

CONSULTANTS



ISSUED FOR BID
TAXIWAY BRAVO WEST
RELOCATION

OWNER



RICHARD B. RUSSELL
REGIONAL AIRPORT
FLOYD COUNTY, GEORGIA

MARK	DATE	DESCRIPTION

CMT PROJECT NO:	22004559-00
CAD DWG FILE:	22004559-EL-1.DWG
DESIGNED BY:	JBH/JMM
DRAWN BY:	JBH
CHECKED BY:	JMM
APPROVED BY:	MJR
COPYRIGHT:	CRAWFORD, MURPHY & TILLY, INC. 2025

SHEET TITLE
**ELECTRICAL CIRCUIT
PLAN - SHEET 2**

55 OF 81
SHEET 55 OF 81

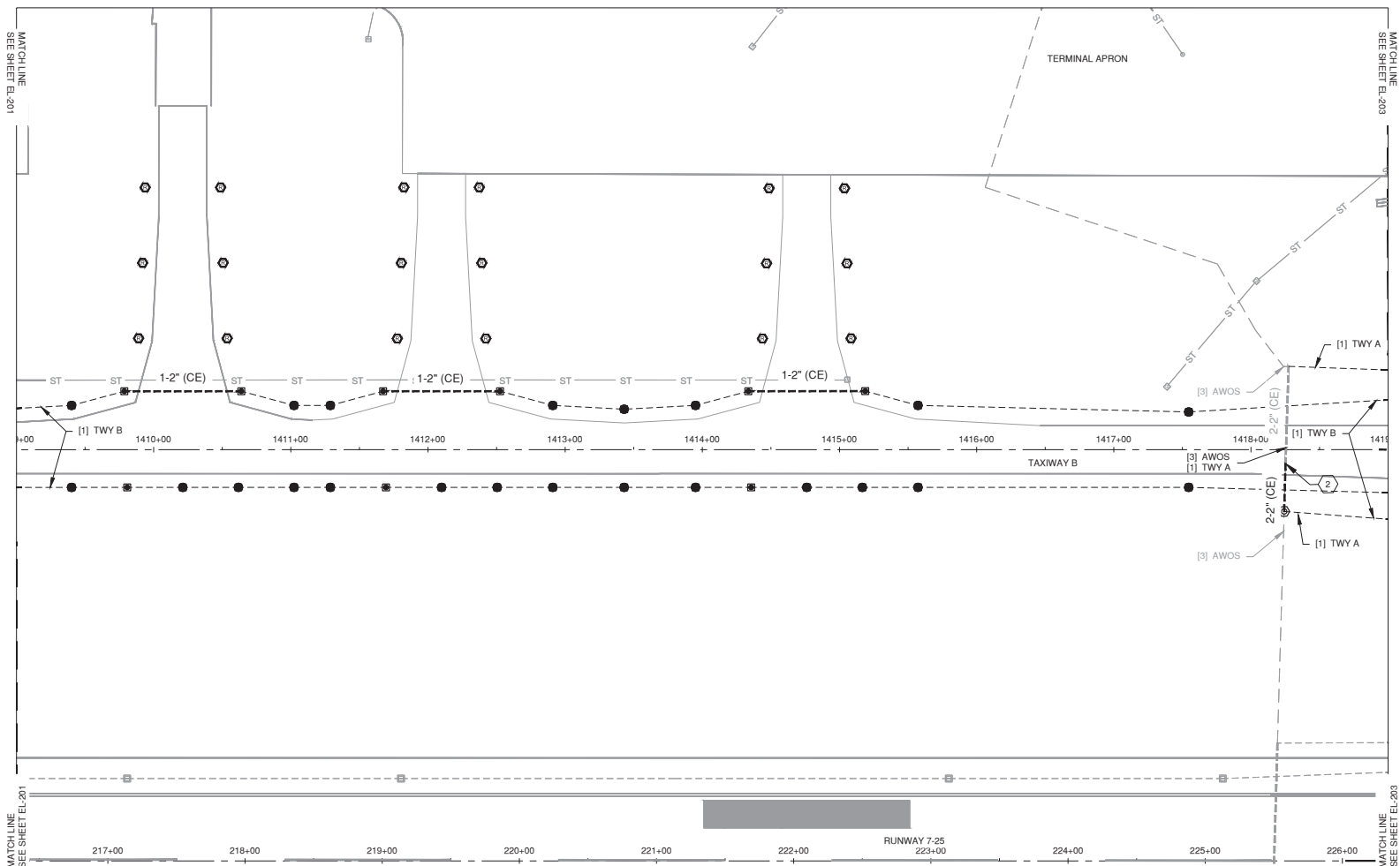

SHEET NOTES

- REFER TO DRAWING EL-500 FOR INFORMATION TO LOCATE SIGNS.
- REFER TO DRAWING EL-100 FOR ELECTRICAL LEGEND AND GENERAL NOTES.

KEYED NOTES

- INSTALL RELOCATED SIGN AND TIE EXISTING CIRCUIT TO RELOCATED SIGN.
- EXTEND EXISTING CONCRETE ENCASED DUCT BANK.
- CONNECT PROPOSED CONDUIT TO EXISTING LIGHT BASE, SIGN OR HANDHOLE. IF NO CONDUIT HUB IS PRESENT, CORE-DRILL THE EXISTING STRUCTURE AND SEAL WITH NON-SHRINK GROUT. THIS WORK SHALL BE CONSIDERED INCIDENTAL TO THE CONDUIT INSTALLATION.
- INSTALL LIGHT AT THE POINT OF TANGENT.

KEYMAP

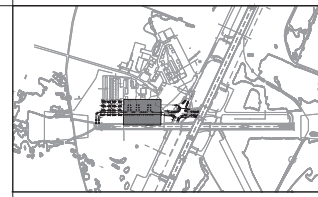

Path: K:\Richard\Russell\A\22004559-00_RMG_D_Taxiway\Realign\Draw\Sheets\22004559-EL-1.dwg
 Date: Tuesday, June 3, 2025 11:20:02 AM