

All components of sewage treatment system (STS) must have a 10' minimum offset from any hardscape or property line and 50' offset from any water source or impoundment

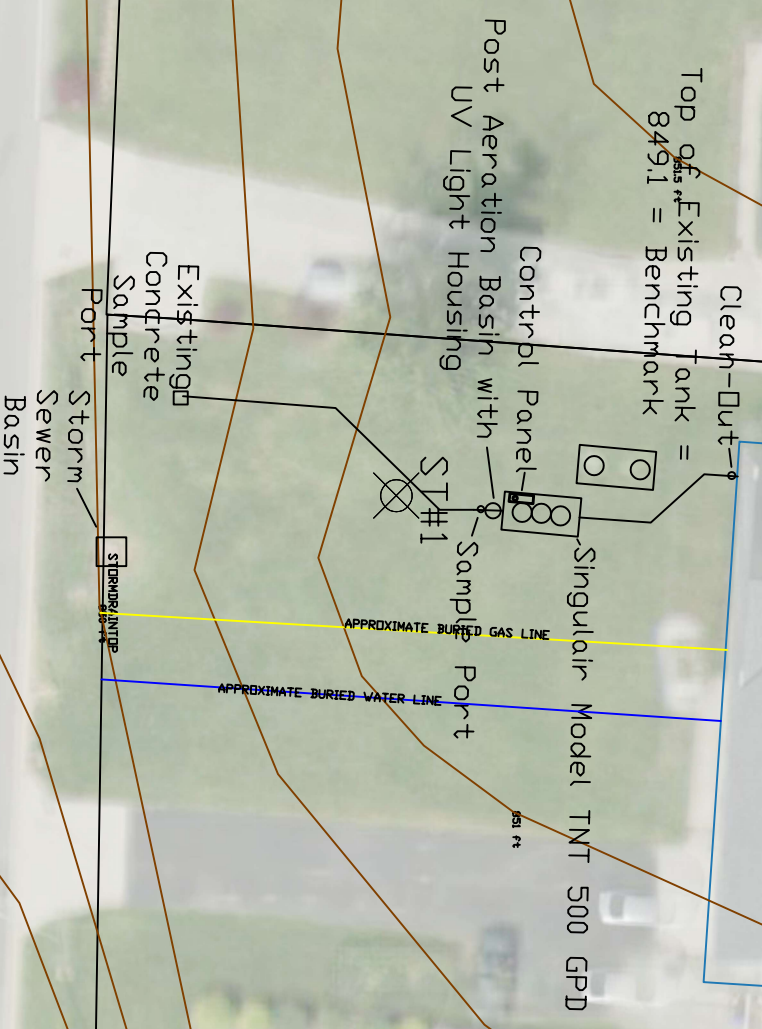
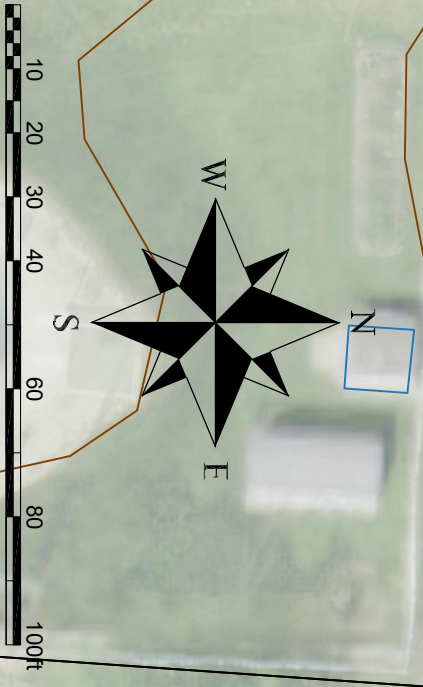

Driveway and utility locations are not to run over proposed septic areas unless alternate septic areas are approved by the Health Department

Caution: Underground utilities may exist on site. Locations must be determined prior to excavation.

Property lines, contours, and existing improvement locations are derived from County GIS data, LIDAR, and/or aerial photos.

TITLE: ATU to DISCHARGE Site Layout	
DR. BY: SAM	
DATE: 06/02/2026	
SCALE: NTS	
FILE: 26D401	
City of Columbus, Franklin County, Ohio	2710 McCutcheon Road Residence
Drawn By: Soil & Environmental Consulting Services, Inc. PO Box 1121 Delaware OH 43015 614-579-1164	

ALL INFORMATION ON THIS PAGE, INCLUDING ELEVATIONS AND LOT DIMENSIONS, IS FOR REFERENCE PURPOSES ONLY AND IS NOT INTENDED TO REPRESENT A LEGAL SURVEY OR DOCUMENT.