

— SLOPE MEASUREMENT PROFILE LOCATION PLAN —
 THE INTENT OF THIS PLAN IS TO SHOW THE LOCATION SHOWN ON THE BROSILE SHEET.
 1. THE EXISTING CONTOUR MAP OF THIS AREA AND REGIONAL FILE 101.
 Terrain Shading which was provided to SANBORN HEAD PRODUCTIONS, SANBORN, VT
 JULY 14, 2022. SURVEY WAS PERFORMED BY TULLY, GEORGE SURVEY ASSOCIATES, LLC.

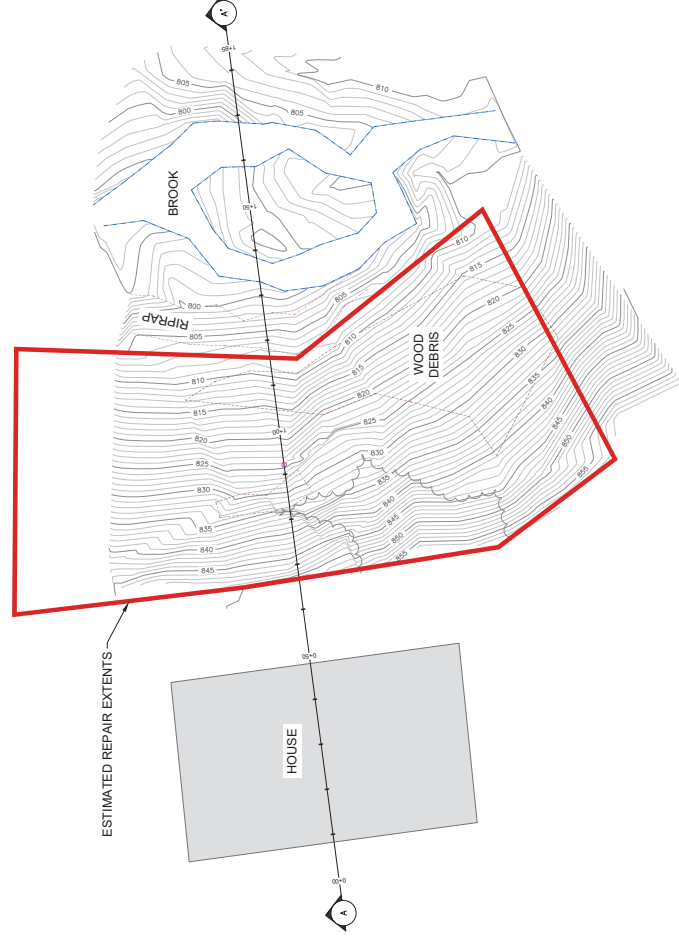

STATE PLANE GRID



GRAPHICAL SCALE
 0 10 20 30 40 50 60 70 80 90 100

ORIGINAL DATE ISSUED: JUNE 19, 2020 REVISIONS



SANBORN HEAD
 187 Saint Paul Street
 Suite 201
 Burlington, VT 05401
 (802) 301-4200

REPAIR EXTENTS LOCATION PLAN
 OWNER: TULLY, GEORGE SURVEY ASSOCIATES, LLC
 PROJECT: ROCHESTER EWP 5041 (NR241800000003) SLOPE STABILIZATION
 LOCATION: 4187 VT ROUTE 100, ROCHESTER, VT
 SANBORN HEAD PROJECT NUMBER: 5342.000

- SLOPE IMPROVEMENT PROFILE VIEWS
- THE INTENT OF THIS IS DRAW TO SHOW THE PROPOSED INSTALLATION OF ALONG THE SLOPE.
1. THE EXISTING SLOPE SURFACE IS BASED ON THE CONTACT INFORMATION PROVIDED IN FILE TITLED "ARMORMAX 75" WHICH WAS PROVIDED TO SANBORN HEAD FROM ARMORMAX CONSULTING, LLC, JULY 14, 2025. SURVEY WAS PERFORMED BY TONY GARDNER, SURVEY ASSOCIATES.
 2. REFER TO ARMORMAX 75 SLOPE INSTALLATION DETAILS PLAN SHEET AND 30' MAX INSTALLATION GUIDELINE PROFEX ARMORMAX FOR SLORES.
 3. PREPARE TO OBTAIN NECESSARY PERMITS AND OBTAIN RECOMMENDATIONS FROM THE STATE OF VERMONT.
 4. THIS REPAIR PREVENTS SURFICIAL FAILURES LIMITED TO THE UPPER FEET OF THE SLOPE FACE. THIS REPAIR DOES NOT PREVENT SLIP SURFACES THAT ARE DEEPER THAN FEET 6. DESIGN AFTER INSTALLATION OF ARMORMAX 75 TO ASSUME NO DEEP SEATED FAILURES ARE OCCURRING.

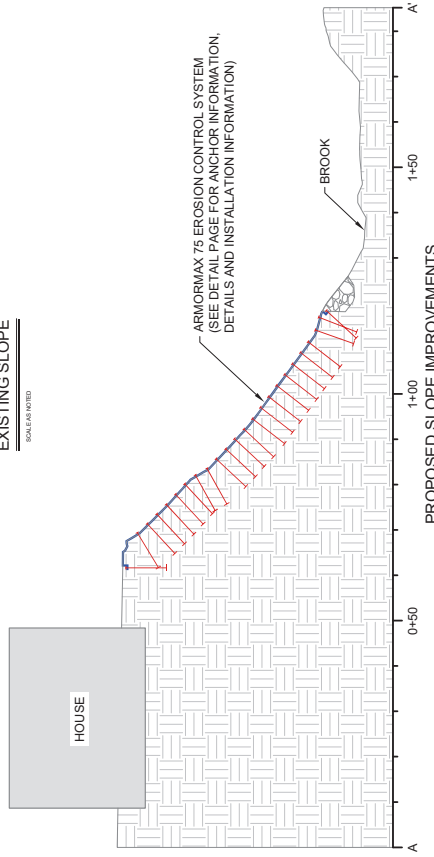
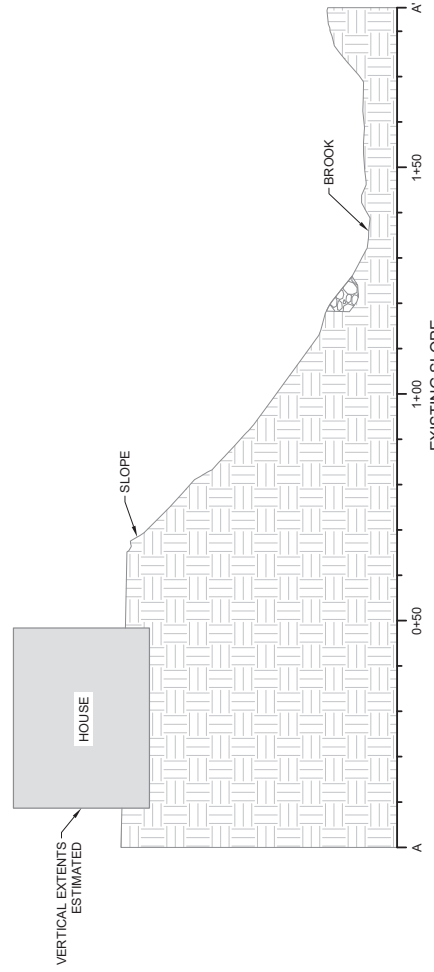

ORIGINAL DATE ISSUED: JUNE 19, 2024
REVISIONS



SANBORN HEAD
187 Saint Paul Street
Suite 201
Burlington, Vermont 05401
(802) 391-4500

SLOPE PROFILES

CONTRACT: 25017A HANES
PROJECT: ROCHESTER EMP 5041 (NR2418000X0003) SLOPE STABILIZATION
LOCATION: 4187 VT ROUTE 100, ROCHESTER, VT
SANBORN HEAD PROJECT NUMBER: 5345.000

